



# INDEX

Sr. No.	NAME OF THE SLUM	PAGE NO.
	<b>New Capital Circle</b>	
1.	YARPUR - 9	01
2.	YARPUR - 19	07
3.	HAZ BHAWAN	13
4.	KAUSHAL NAGAR	21
5.	R- BLOCK	27
6.	ADALATGANJ	33
	<b>Patliputra Circle</b>	
7.	BANSKOTHI	41
8.	SHASTRINAGAR (PWD)	47
	<b>Bankipore Circle</b>	
9.	NAND NAGAR	56
10.	RAMPUR BASTI	65
11.	OLD & NEW AMBEDKAR COLONY	71

# SLUM DEVELOPMENT PLAN



**Yarpur, Ward no. 09**  
New Capital Circle (NCC)

## Background of the Slum

Yarpur slum is situated along the railway track in a stretch of 900 meter near the NCC circle office. There are 250 households of Dom community residing here. Most of the people residing here are daily wage workers, sanitation workers and laborers. The women of this slum are traditionally engaged as house help. There is one community toilet at present and one more was supposed to be built but till now there is no progress or sign of its construction. As the whole community is dependent on a single community toilet which is not very feasible or adequate for all the people of the slum to use. So, there is a problem of open defecation and they defecate around the railway track. There are two other toilets situated nearby the slum that are not functional.

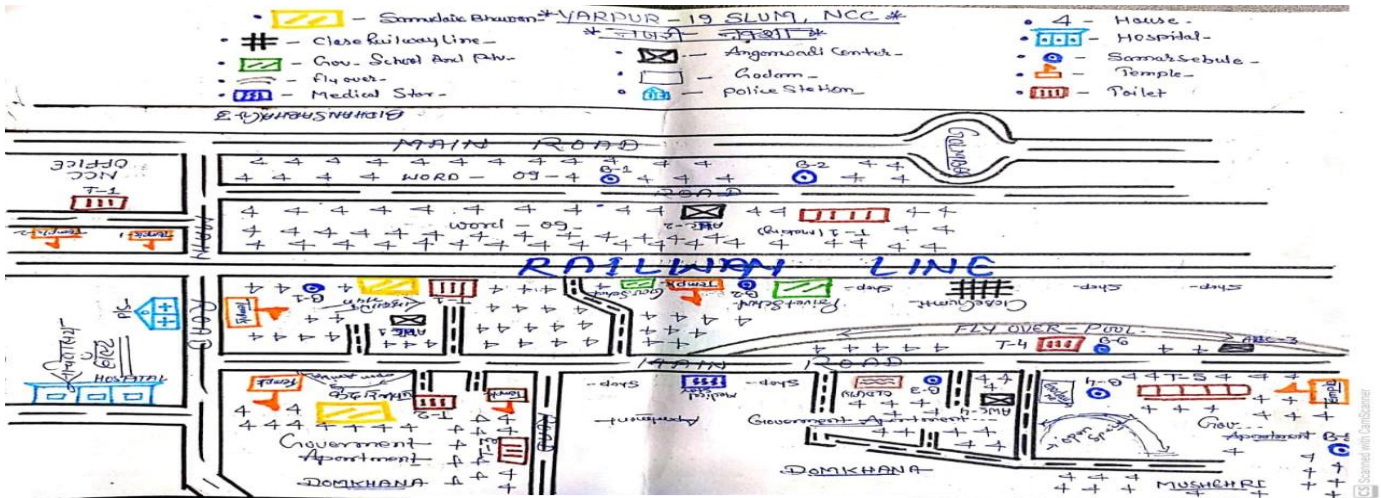

Physical map of Yarpur slum

There is one Aganwadi Centre (AWC) in the slum. There are 30 children enrolled in Aganwadi Centre and 25 children visit it on a daily basis. Children of this slum do not attend schools and the parents are reluctant to send their children to school. The primary school is about 200 meters away from the slum. Gardaniabagh District Hospital is the nearest hospital from the community and people visit it in case of any health issues. The hospital is about half a kilometre from the slum. There have been 8 health camps organized by District health society in the last 1 year. The drainage system in the slum is in very poor condition. The main Drainage beside the slum is over flooded and the dirty water of the drainage always comes in the slum. Especially during the rainy season, it becomes flooded.

## Structure of the Development Plan

The plan discusses the current situation of the slums. It combines the crucial information on Demography, physical infrastructure, health and slum dynamics and sanitation indicators. The information is crucial to set up the baseline of the development plan. In the subsequent sections the plan discusses about the gap which is visible for a more robust and inclusive services for the development plan. The gap focuses on infrastructure services, social capital and strengthening the health services. The last section explicitly focuses on the intervention plans supported by the photographs. The drainage blockage and community toilets are intrinsic part of the current intervention strategy for the project.

## Current Status at a Glance (SLUM):

SR. NO	PARTICULAR	SPECIFICATION	REMARKS
<b>Demography of the slum</b>			
1.	Nearest Landmark	NCC circle office	
2.	Total Household	250	
3.	Total Population	1600	
4.	Majority- Caste wise/Religion wise	SC (Harijan)	
5.	Male	850 Approx.	Source: ward councilor
6.	Female	750 Approx.	
<b>Physical Infrastructure of the slum</b>			
7.	Open Space in slum, if yes then how many	1	Near Borewell
8.	No. of Community toilet	3	Functional: 1
9.	No. of total units/seats	26	Mentioned in the report
10.	Community toilet run by whom? -	PMC	3 toilets run by PMC
11.	Number of bore well	3	
12.	Number of functional bore wells	3	
13.	Number of hand pump	0	
14.	Number of functional hand pump	0	
15.	No. of street lights in the slums	11	Need to be Install
16.	Nearest Aanganwadi Centre (Distance from slum)	1 Anganwadi is in the slum	Functional
<b>Health</b>			
17.	Nearest PHC (Distance from Slum)	500 m	Name: UPHC Gardanibagh
18.	Nearest Govt. School (Distance from slum)	1 Government school beside the slum in ward 19.	Primary school, Yarpur
19.	Is there Asha worker in the slum/Ward	NO	
<b>Slum dynamics</b>			
20.	Major occupation of people living in the slum	Daily wagers, Sanitation Workers, Laborer.	
21.	Is there concrete road in the slum	Yes	
22.	Is there proper drainage system	No	
23.	Situation of slum during rainy season?	Water logging, Flooding	Water is logged completely.
24.	No. of out of school children	12 (Age group 7 - 19)	Female - 07 & Male - 05
25.	No. of Person with Disability	1	
26.	No. of Sanitation Worker	PMC recruited 11	
<b>Sanitation</b>			
27.	Status of Door-to-door collection	Daily collection done through E-cart and Hand cart between 6 am - 11am	Rohit Kumar, 9619910476
28.	Status of brooming	Not initiated yet	Issue has been escalated to City Manager & CSI.



## Existing gaps in the slum at the infrastructure level:

Sr No.	Status of Infrastructure services	Numbers	Current status	Work needs to be done
1.	Road	1	Concrete	Maintenance of Concrete needs to be done.
2.	Public Toilet	3	1 is working	2 community toilets are locked. Need to be open and clean.
3.	Drainage	1	1 main drainage	Cleaning work is required
4.	Street Light	11	Non functional	11 street lights need to be repair
5.	Water supply	Doesn't Exist	Water supply line is needed.	Pipeline connection is required. Few people have done private connection for the water.
6.	Earthwork	Filling and leveling of land are needed near the railway track ground		Filling & Levelling, converted in to dumping point which needs to be clean.
7.	Hand pump	Doesn't exist		

Social Capital		
1.	Youth Collective	30 Members
2.	Women Collective	20 Members
3.	SHG under NULM	Doesn't exist in the community
4.	Monitoring Committee	1 group consisting of 5 people
5.	Social Action/Leadership: Discussion with collectives on social issues like Gender based violence, Child marriage, visioning in slums, Health, Sexual & reproductive health rights, Menstrual health and hygiene etc.	
Strengthen Health		
1.	Aware people regarding role of UPHCs/ASHA/AWC	In Process
2.	Health/Vaccination camps: Health camps need to be organized on Monthly basis.	In Process

## Development Plan

### Toilet:

Sr.No.	Type of toilet	Seat	Issue	Remarks
1.	Community	9	Currently not in use and functional. Mostly toilet is kept locked. Taps are broken. Seats are jammed	HH covered: 50 (Appx Population: 250 covered). Current Load on toilet: 25 people per seat. <b>Requirement: 16 seats</b>
2.	Community	8	Currently not functional. As their toilets seats for female is also settled, they not able to use it.	HH covered:30 (Appx Population: 150 covered). Current Load on toilet: 15 people per seat. <b>Requirement: 07 seats</b>

3.	Modular	10	Not functional, All the seats are broken. Taps are damaged. Doors are also coming out and broken. Septic tank also needs to clean.	HH covered: 100 (Appx Population: 500 covered). Current Load on toilet: 50 people per seat. <b>Requirement: 40 seats</b>
----	---------	----	--	--

**Note:** Total number of toilets is having 27 number of seats. The load over one seat is of around 21 people. Seeing this there is need of around 63 seats at present.

### Action Required for above mentioned toilet issues:

- Should be open on daily basis for all.
- Regular cleaning process required.
- Taps need to be repair.
- Local community person needs to be appointed for the maintenance.
- Capacitate our collectives for maintenance of assets.
- Generate social awareness among the community with the help of our collectives. Need a strong effective session.
- To activated Monitoring Committee to ensure daily monitoring report.



9-seater modular toilet



10-seater modular toilet



8-seater community toilet

### Blockage of drainage:

There are two main manholes need to be clean on urgent basis near the modular toilet and borewell. Due to blockage of these manholes, there is issue of water logging in the area.

**Suggestion:** Swachhngini team can clean the septic tank.



Blockage of manhole in ward 09 Yarpur

Sr.No.	Issue	Action Required
1.	The main drainage of the slum is blocked due to waste dumping	Need to be clean on regular basis to avoid blockage
2.	The door-to-door vehicle not able to visit in the street	Need to place a big dustbin in the slum
3.	Littering of garbage by the people	Poster of strict messages of fine should be pasted in the slum.

## Water Resources:

There is only one main borewell situated near the modular toilet, people have to come up with the utensils and bucket to fetch the water for drinking and for bathing. Female also use to bath in open near the bore well. So, there is need of tap water facilities in every houses. Some people have started the installation of water pipeline supply by their own.



## Open Space/Available:

In the opposite of modular toilet and borewell there is an empty space available, community has given the suggestion that we can construct community hall/ toilet which can be used for multipurpose use.



## Recommendation:

- Toilets need to be repaired on urgent basis, especially the community toilet.
- Open the locked community and Modular toilet behind the NCC circle office.
- Borewell base platform need to repair, broken due to water logging.
- Uneven land of the slum needs to be fill to avoid the water logging.
- Open bathing space needs to covered with boundary wall.
- Waste collection & brooming needs to be done on a daily basis. Dustbins are needed for the slum.



# SLUM DEVELOPMENT PLAN

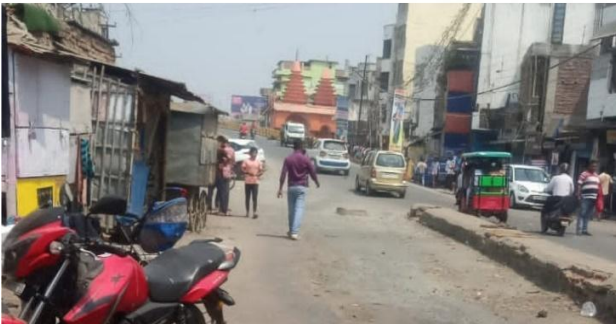

**Yarpur, Ward - 19**  
New Capital Circle (NCC)



## Background of the Slum

Yarpur Mushahari slum is situated in ward 19 of NCC circle, this slum was formed early in 1980s. There are about **900 households** and people from castes like SC & ST (Harijan, Dom and Mushahar). This slum is settled on government land. The population of this slum is more than 4000. Rajiv Awaas Yojna was proposed for this slum, and BUIDCO was supposed to develop 439 residential units and the work was supposed to be completed by 2017 only. At present only two buildings are ready which have **48 flats**. But this has also not been allotted

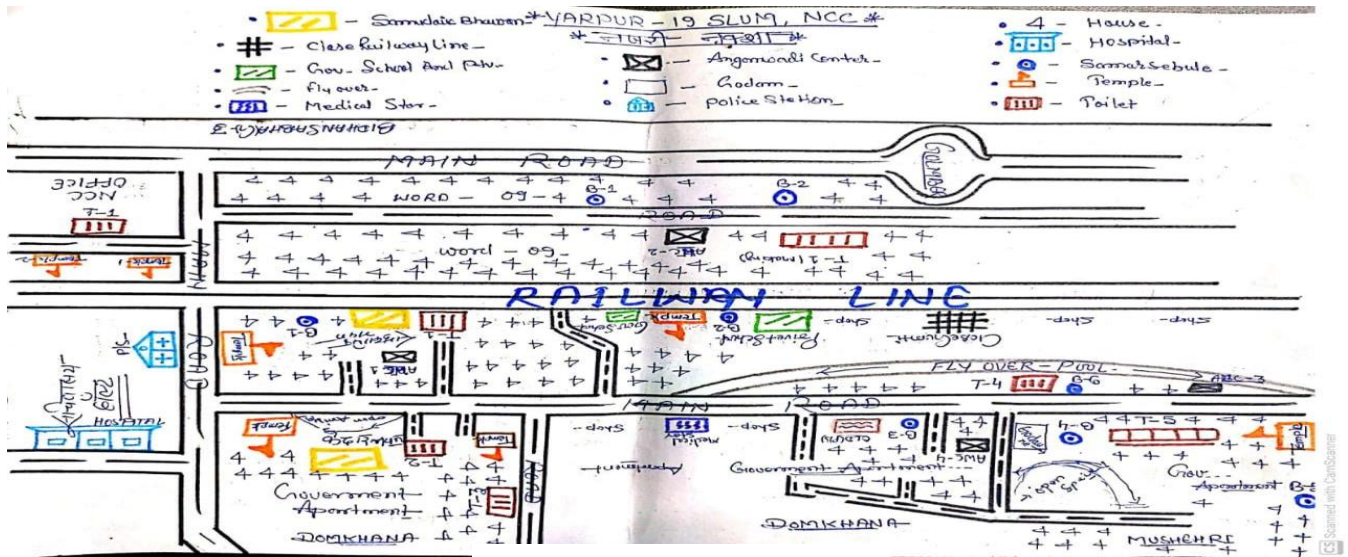

to anyone. Mostly people residing here indulge in professions like sanitation work, few work for Nigam and few work in malls and shopping complex as sanitation workers, daily wage and in rag picking. There are 4 Anganwadi Centre (AWC) in the slum and 30 children are enrolled in each of them. These Anganwadi Centre's are not active at present due to corona pandemic. There is a middle school (*Madhyamik Vidyalaya*) nearby the slum, where children from slum go for their primary education. But still many children are not enrolled in school. For medical facility people visit Gardanibagh District Hospital which is about 500 meters from the community. There are two bore wells, one is having a tank with it. But it's not enough for the community, as it is highly populated. There is no proper bathing space, women and girls have to take baths in open space. Drainage and sanitation are a big issue for this slum. There are few chambers in Shivaji Path which are not connected and because of this water does not flow from the drains, and this creates a problem of water logging. During the rainy season this slum becomes flooded.

## Structure of the Development Plan

The plan discusses the current situation of the slums. It combines the crucial information on Demography, physical infrastructure, health and slum dynamics and sanitation indicators. The information is crucial to set up the baseline of the development plan. In the subsequent sections the plan discusses about the gap which is visible for a more robust and inclusive services for the development plan. The gap focuses on infrastructure services, social capital and strengthening the health services. The last section explicitly focuses on the intervention plans supported by the photographs. The drainage blockage and community toilets are intrinsic part of the current intervention strategy for the project.

## Current Status at a Glance (SLUM):

Sr. No.	PARTICULAR	SPECIFICATION	REMARKS
<b>Demography of the slum</b>			
1.	Nearest Landmark	Bagh Murti Temple, Adarsh Police Station	
2.	Total Household	900 Approx.	
3.	Total Population	4000	
4.	Majority- Caste wise/Religion wise	SC (Harijan)	
5.	Male	2200 Approx.	Source: ward councilor
6.	Female	1800 Approx.	
<b>Physical Infrastructure of the slum</b>			
7.	Open Space in slum, if yes then how many	Yes	
8.	No. of Community toilet	4	Functional: 2
9.	No. of total units/seats	37	Details provided in the next page.
10.	Community toilet run by whom? -	PMC	4 toilets of PMC
11.	Number of bore well	5	
12.	Number of functional bore wells	3	
13.	Number of hand pump	0	
14.	Number of functional hand pump	0	
15.	No. of street lights	13	Installation of 13 street light
16.	Nearest Aanganwadi Centre (Distance from slum)	4 Anganwadi is in the slum	Functional
<b>Health</b>			
17.	Nearest PHC (Distance from Slum)	UPHC Gardanibagh 100 m, Gardanibagh District Hospital	Same premises for both
18.	Nearest Govt. School (Distance from slum)	1 Government school in the slum	Middle school, Yarpur
19.	Is there Asha worker in the slum/Ward	Yes	6 Asha workers are there
<b>Slum dynamics</b>			
20.	Major occupation of people living in the slum	Daily wager, sanitation worker, septic tank cleaner and rag picker	
21.	Is there concrete road in the slum	No	
22.	Is there proper drainage system in the slum	No	
23.	Situation of slums during the rainy season?	Accumulation of water	Water is logged completely.
24.	No. of out of school children	15 (Age group 8 - 19)	Female - 09 & Male - 04
25.	No. of Person with disability	04 People	
26.	No. of Sanitation Workers	80 SW of PMC	
<b>Sanitation</b>			
27.	Status of Door-to-door collection	Daily collection done through E-cart and Hand cart between 6 am - 11am	Dilip Kumar, Mob - 6361901818
28.	Status of brooming	Not initiated yet	Issue has been escalated to respective City Manager & CSI.

## Existing gaps in the slum at the infrastructure level:

Sr. No.	Status of Infrastructure services	Numbers	Current status	Work needs to be done
1.	Road	0	Damaged	Maintenance work
2.	Street	0	Construction required	Construction required
3.	Public Toilet	4	2 is working	2 community toilets are locked. Need to be open and clean. 1 is completely broken.
4.	Drainage	1	1 main drainage	Cleaning work is required
5.	Street Light			Installation needed
6.	Water supply	5 Borewells	2 are non-functional	Pipeline connection is required
7.	Earthwork	Filling and leveling of land are needed near the railway track ground		Filling & Levelling, converted into a dumping point, needs to be clean.
8.	Hand pump	0	Required	4 Hand pump required in the slum

<b>2.</b>	<b>Social Capital</b>	
1.	Youth Collective	30 Members
2.	Women Collective	20 Members
3.	SHG under NULM	Doesn't exist
4.	Monitoring Committee	1 group consisting of 5 members
5.	Social Action/Leadership: Discussion with collectives on social issues like Gender based violence, Child marriage, visioning in slums, Health, Sexual & reproductive health rights, Menstrual health and hygiene etc.	
<b>3.</b>	<b>Strengthen Health</b>	
1.	Aware people regarding role of UPHCs/ASHA/AWC	In Process
2.	Health/Vaccination camps: Health camps need to be organized on Monthly basis.	In Process

## Development Plan:

### Toilet:

Sr. No	Type of toilet	Seat	Issue	Remarks
1.	Community	8	Not functional currently. The toilet has been locked for a long time. The community people have no access to use it. Due to poor maintenance, it had been locked by WC.	HH covered: 120 (Appx Population: 600 covered). Current Load on toilet: 60 people per seat. <b>Requirement: 52 seats</b>
2.	Community	13	Currently in use, Maintenance is average. Taps are working. Outside 2 wash basins are broken, taps are not working.	HH covered: 180 (Appx Population: 900 covered). Current Load on toilet: 90 people per seat. <b>Requirement: 83 seats</b>

3.	Community	12	This is not functional; the toilet is completely in poor condition. Need to be constructed in a new form.	HH covered: 150 (Appx Population: 750 covered). Current Load on toilet: 75 people per seat. <b>Requirement: 63 seats.</b>
4.	Community	4	This is a functional toilet of the slum built behind the Ambedkar colony Domkhana. There are 2 seats for male and 2 seats for females available.	HH covered: 200 (Appx Population: 1000 covered). Current Load on toilet: 100 people per seat. <b>Requirement: 96 seats.</b>
5.	Community	6	They have just initiated the construction work.	Post construction it can be used by community people.

**Note:** Total number of toilets has **37 seats**. The load over one seat is around **80** people. Seeing this there is a need of around **294 seats at present**.

### Action Required for above mentioned toilet issues:

- Regular cleaning process required.
- Taps need to be repaired.
- Local community person needs to be appointed for the maintenance.
- Community awareness as the social capital should be raised to pay for the maintenance.
- Generate social awareness among the community with the help of our collectives. Need a strong effective session.



### Blockage of drainage:

In Domkhana basti, near the old toilet the manholes are completely blocked, the dirty water of the drainage running above it, community people are facing trouble due to waterlogging and bad smells. It is also dangerous for the young children playing around.





Sr. No.	Issue	Action Required
1.	The main drainage of the slum is blocked by throwing the garbage	Need to be clean on regular basis to avoid blockage
2.	The door-to-door vehicle not able to visit in the street	Need to place a big dustbin in the slum
3.	Waste dumping	Strict messages for the fine are to print and stick on the main locations of the slum.

### Water Resources:

There is a need for installation of tap water in every house. Females have to fetch the water through borewells far from the houses for daily chores.



### Open Space:

There is an empty land near the Baghmurti temple. Last year on the commissioner visit this empty land was selected for the construction of the community toilet.



### Recommendation:

- Toilets need to be repaired on urgent basis, especially the community toilet, that chamber needs to be re-constructed.
- Open the locked community and Modular toilet behind the NCC circle office.
- The Borewell base platform needs to be repaired, broken due to water logging.
- Uneven land of the slum needs to be filled to avoid the water logging.
- Open bathing space needs to be made useful by shading and covering it with boundary walls.
- Waste collection needs to be collected door to door and brooming needs to be done on a daily basis. Dustbins are needed for the slum.

# SLUM DEVELOPMENT PLAN



**Haz Bhawan**  
New Capital Circle (NCC)

## Background of the Slum

Haz Bhawan Slum basti is situated behind the Haz Bhawan and henceforth named after it. This slum was formed in the year 1970. There are about **180** households of SC and OBC communities residing here. Most of the people residing here are daily wagers, sanitation workers and laborers. For primary education, there is one Anganwadi Centre (AWC) that covers the whole basti and one primary school situated in the slum itself, reducing the travel time for the kids. There is no PHC in the slum or nearby. People of this community visit Gardanibagh District Hospital and Girija Hospital for their treatment. The Gardanibagh District Hospital is about two kilometers away from the slum.

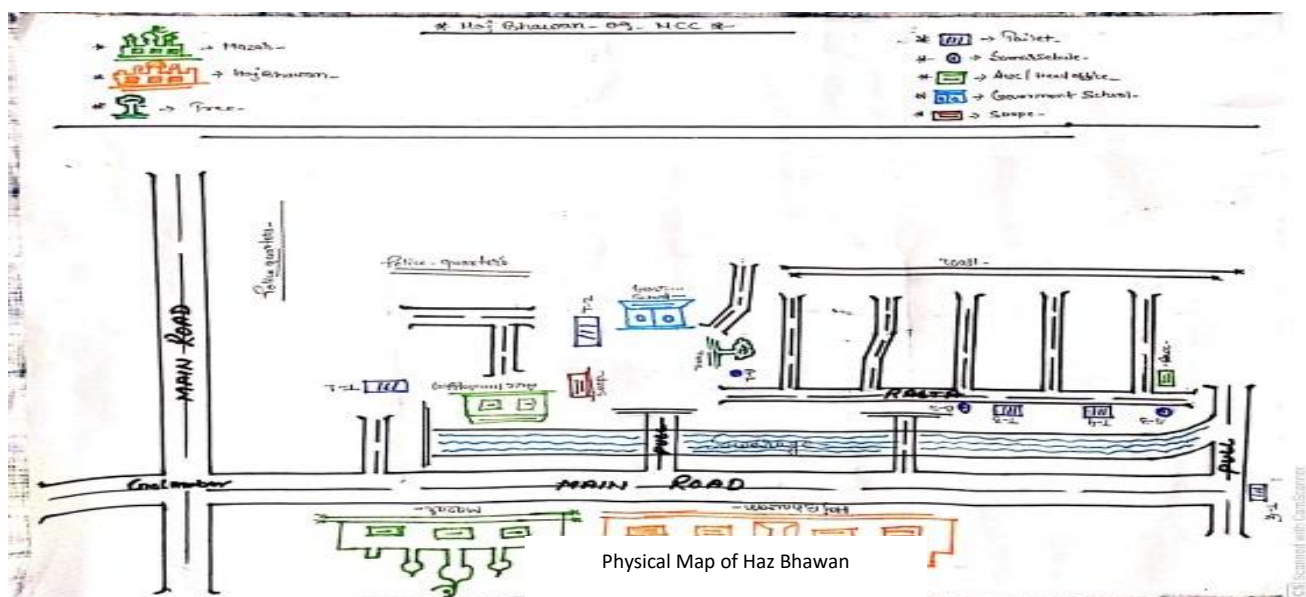

There is one community toilet, and some people have even made their own temporary toilet. There is one community toilet in the slum but it is little separated from the basti. To access water facilities, they have four borewells and six hand pumps for water supply in the slum out of which 3 hand pumps are in working condition and other 3 are not in working condition and in case of borewells, 2 are not operational as of yet. The basic problem of the slum is the unavailability of Ration Cards. Many people in this slum do not have ration cards. (Shared by community people). Drainage beside the slum is always over flooded and the dirty water of the drainage always comes in the slum. Especially during the rainy season, it becomes flooded.

## Structure of the Development Plan

The plan discusses the current situation of the slums. It combines the crucial information on Demography, physical infrastructure, health and slum dynamics and sanitation indicators. The information is crucial to set up the baseline of the development plan. In the subsequent sections the plan discusses the gap which is visible for more robust and inclusive services for the development plan. The gap focuses on infrastructure services, social capital and strengthening the health services. The last section explicitly focuses on the intervention plans supported by the photographs. The drainage blockage and community toilets are intrinsic part of the current intervention strategy for the project.

## Current Status at a Glance (SLUM):

Sr. No.	Indication	Current Status	Remarks
<b>Demography</b>			
1.	Nearest Landmark	Haz Bhawan (Sahgadi Masjid)	
2.	Area in Sq. Feet	1,36100 sq. Feet	
3.	Total Household	180	
4.	Total Population	900	
5.	Majority- Caste wise/Religion wise	Hindu, SC (Harijan)	
6.	Male	480	Source: ward councilor
7.	Female	420	
<b>Physical Infrastructure</b>			
9.	Open Space in slum, if yes then how many	Yes, 1	Near the community toilet besides the main road.
10.	No. of Community toilet	3	Functional: 2
11.	No. of total units/seats	26	Details provided in the next page.
12.	Community toilet run by whom?	PMC	
13.	Number of bore well in the slum	4	
14.	Number of functional bore wells	4	
15.	Number of hand pump	2	Out of order
16.	Number of functional hand pump	0	
17.	No. of street lights in the slums	08	All of them are Non-Functional
18.	Nearest Anganwadi Centre (Distance from slum)	1 Anganwadi is in the slum	Functional
<b>Health</b>			
20.	Nearest PHC (Distance from Slum)	1 km	Name: UPHC Kaushal Nagar
21.	Nearest Govt. School (Distance from slum)	1 Government school is in the slum	Primary school, East of Sardar Patel Golumber
22.	Is there Asha worker in the slum/Ward	One Asha worker is in the slum	
<b>Slum dynamics</b>			
24.	Major occupation of people living in the slum	Daily wager, Sanitation Worker, Laborers and house help.	
25.	Is there concrete road in the slum	Yes	Currently many roads are damaged due to water logging in the rainy season.
26.	Is there proper drainage system in the slum	No	1 main drainage needs to be repaired with the boundary wall.
27.	Flood scenario in 2019? Or even in this year's rain.	Flooded completely	Uneven land leads to this situation.
28.	Situation of slums during the rainy season?	Accumulation of water around houses	Waterlogging completely.
29.	No. of out of school children	12 (Age group 6 - 19)	Female - 08 & Male - 04
30.	No. of Sanitation Worker	15 people	



31.	No. of Person with Disability	08 people	Intellectual Disability:03, Blindness: 01, Locomotor Disability: 03 & Hearing Impairment: 01
<b>Sanitation</b>			
32.	Status of Door-to-door collection	Daily collection done through E-cart and Hand cart between 6 am - 11am	Pankaj kumar, 8935843993
33.	Status of brooming	Initiated in the slum	Monitoring on daily basis

### Existing gaps in the slum at the infrastructure level:

Sr. No.	Status of Infrastructure services	Numbers	Current status	Work needs to be done
1.	Road	1	Raw (Kaccha) & broken	Concrete/Paver
2.	Street	4	Raw and muddy	Leveling, concrete work and Paver work is needed.
3.	Public Toilet	4	3 is working	In a 12-seater toilet the leveling of the tank is not proper so is not working properly.
4.	Drainage	1	1 main drainage	Cleaning, repairing the boundary wall
5.	Street Light	8	3 is not working	Need to be repair
6.	Water supply	0	Water supply line is needed.	350 HH is waiting for the piping and connection
7.	Earthwork	Filling and leveling of land are needed near the school ground		Filling & leveling
8.	Hand pump	2	Out of order	Need to repair

<b>2.</b>	<b>Social Capital</b>	
1.	Youth Collective	30 Members
2.	Women Collective	20 Members
3.	SHG under NULM	Doesn't exist
4.	Monitoring Committee	1 group consisting of 3 members
5.	Social Action/Leadership: Discussion with collectives on social issues like Gender based violence, Child marriage, visioning in slums, Health, Sexual & reproductive health rights, Menstrual health and hygiene etc.	
<b>3.</b>	<b>Strengthen Health</b>	
1.	Aware people regarding role of UPHCs/ASHA/AWC	In Process
2.	Health/Vaccination camps: Health camps need to be organized on Monthly basis.	In Process

## Development Plan

### Toilet:

Sr. No.	Type of toilet	Seat	Issue	Remarks
1.	Community	12	There is an issue in the leveling of the toilet tank. The connection from the toilet is not working. Water taps are jam.	HH covered: 50 (Appx Population: 250 covered). Current Load on toilet: 25 people per seat. <b>Requirement: 13 seats</b>
2.	Community	10	The roof of the toilet is broken due to continuous water flow from the water tank. Piping of the water tank is not arranged	HH covered: 100 (Appx Population: 500 covered). Current Load on toilet: 50 people per seat. <b>Requirement: 46 seats</b>
3.	Modular	4	Water supply has not been done yet. Toilet accessories about to break due to low maintenance. As water is not flowing, seating pots are about to get jammed.	HH covered: 150 (Appx Population: 750 covered). Current Load on toilet: 75 people per seat. <b>Requirement: 65 seats</b>

**Note:** Total number of toilets has **26 seats**. The load over one seat is around **40** people. Seeing this there is a need of around **124 seats at present**.

### Action Required for above - mentioned toilet issues:

- Need to repair and level the septic tank as the position of the tank is not appropriate (community toilet situated on main road).
- Need to replace the water taps that are broken in every toilet.
- Electricity is needed in every toilet or street light in the toilets.
- Need to establish electric supply with water connection in the 10-seater modular toilet.
- Roof of the Community toilet in the slum is broken and the water from the tank directly comes in the toilets.
- Need to ensure cleaning and maintenance of toilets on a regular basis.

### Open Space:



Sr. No.	Issue	Action Required	Remarks
1	The land is empty and not in use, the waste and mud are accumulated. The provisioning of the park can be considered here	Need land filling & leveling. Plantation is needed. Park can be constructed here for the beautification of the location.	The location is just in front of the community toilet

## Drainage Blockage:



Sr. No.	Issue	Action Required
1.	The main drainage of the slum is blocked due to waste dumping	Need to be clean on regular basis to avoid blockage
2.	The door-to-door vehicle is not able to visit narrow streets.	Need to place a big dustbin in the slum
3.	Garbage thrown by the people	Strict messages for the fine are to print and stick on the main locations of the slum.

## Water logging:



Sr. No.	Issue	Action Required
1.	Blockage of main drainage	Need to clean on regular basis
2.	Broken drainage	Need to build boundary wall of main drainage
3.	Levelling off the ground	The slum land is very low from the drainage, it needs to be proper levelling
4.	Throwing garbage by the people	Strict messages for the fine are print and stick every main location of the slum.



## Construction of slum road & street



Sr. No.	Issue	Action Required	Remarks
1.	Inside the slum the street is very muddy and raw, it's very difficult to enter the houses. It became worse during the rain.	Need to leveling and provision of paved roads can be considered.	Approx. length of the street is 500 mt

## Water Resources:



Sr. No.	Issue	Action Required
1.	2 main hand pumps are out of order and not in use from many months	Need to be repaired

## Open Bathing space:





Sr. No.	Issue	Action Required
1.	There is an open bathing space with the water tap available across the main road of the slum, but the land is uneven and full of waste and mud.	Leveling of land needs to be done. A shade is needed as females have to bathe here. It will also help in avoiding the gathering of animals.

## Waste Management:



Sr. No.	Issue	Action Required
1.	Accumulation of garbage	Need Big Dustbins separate for Dry/wet waste
2.	Not proper location for throwing garbage	Provisioning of dustbin
3.	Irregular Door to door vehicle	Regular door to door waste collection needs to be provision
4.	Throwing garbage by the people in the drainage	Provision of door-to-door waste collection to be done

## Recommendations:

- Toilets need to be repaired on urgent basis, especially the community toilet, that chamber needs to be re-constructed.
- Borewell electrical supply line need to be repair
- Uneven land of the slum needs to be fill to avoid the water logging
- Open bathing space needs to be made useful by shading and covering it with boundary walls.
- Waste collection needs to be collected door to door and brooming needs to be done on a daily basis. Dustbins are needed for the slum.

# SLUM DEVELOPMENT PLAN



## Kaushal Nagar, Ward - 09 New Capital Circle (NCC)

## Background of the Slum

Kaushal Nagar slum is situated in ward 09 of NCC circle, this slum was formed early in 1970s. There are about **900 households** and people from castes like SC & ST (Harijan, Dom and Mushahar). This slum is settled on government land. The population of this slum is more than 4500.

Mostly people residing here indulge in professions like sanitation work (Private), few work for Nigam and few work as vendors, daily wage and Shops.

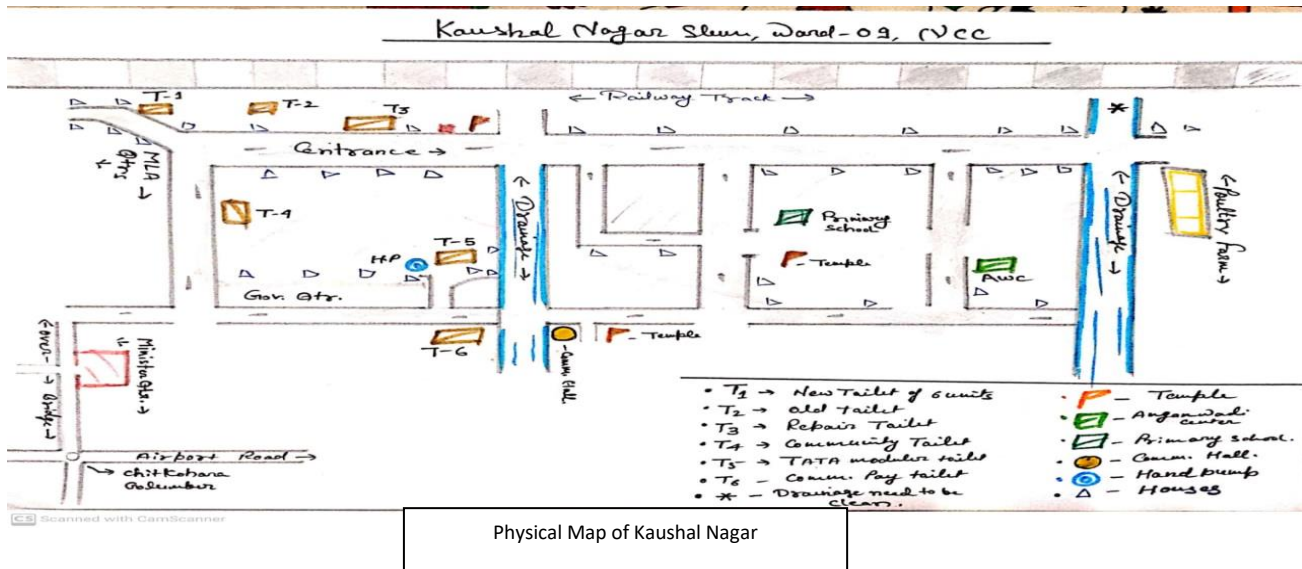

There is one Anganwadi Centre (AWC) in the slum and 30 children are enrolled in each of them. These Anganwadi centers are not active at present due to the corona pandemic. There is a primary school (*Prathmik Vidyalaya*) in the slum, where children from slum go for their primary education. But still many children are not enrolled in school. For medical facilities people visit UPHC Kaushal Nagar which is situated in the slum. There are four bore wells, all having a tank with it. But it's not enough for the community, as it is highly populated. There is no proper bathing space, women and girls have to take baths in open space. Drainage and sanitation are a big issue for this slum. There are few chambers in slums which are not connected and because of this water does not flow from the drains, and this creates a problem of water logging. During the rainy season this slum becomes flooded. The main drainage of the slum is also full of mud that is only cleaned up before the rainy season only.

## Structure of the Development Plan

The plan discusses the current situation of the slums. It combines the crucial information on Demography, physical infrastructure, health and slum dynamics and sanitation indicators. The information is crucial to set up the baseline of the development plan. In the subsequent sections the plan discusses the gap which is visible for more robust and inclusive services for the development plan. The gap focuses on infrastructure services, social capital and strengthening the health services. The last section explicitly focuses on the intervention plans supported by the photographs. The drainage blockage and community toilets are intrinsic part of the current intervention strategy for the project.



## Current Status at a Glance (SLUM):

Sr. No.	Indications	Current Status	Remarks
<b>Demography</b>			
1.	Nearest Landmark	Chitkohara Over bridge	
2.	Total Household	900 Approx.	
3.	Total Population	4500	
4.	Majority- Caste wise/Religion wise	SC (Harijan)	
5.	Male	2200 Approx.	Source: ward councillor
6.	Female	1800 Approx.	
<b>Physical Infrastructure</b>			
7.	Open Space in slum, if yes then how many	No	
8.	No. of Community toilet	3	Functional: 3
9.	No. of total units/seats	23	Details provided in the next page.
10.	Community toilet run by whom? -	PMC	3 toilets of PMC
11.	Number of bore well in the slum	4	
12.	Number of functional bore wells	4	
13.	Number of hand pump	4	
14.	Number of functional hand pump	1	
15.	No. of street lights in the slums	22	08 is Non-Functional
16.	Nearest Aanganwadi Centre (Distance from slum)	1 Anganwadi is in the slum	Functional
<b>Health</b>			
17.	Nearest PHC (Distance from Slum)	UPHC Kaushal Nagar,	In the slum
18.	Nearest Govt. School (Distance from slum)	1 Government school in the slum	Primary school, Kaushal Nagar
19.	Is there Asha worker in the slum/Ward	No	
<b>Slum dynamics</b>			
20.	Major occupation of people living in the slum	Daily wager, sanitation worker, Market vendor	
21.	Is there concrete road in the slum	Yes	
22.	Is there proper drainage system in the slum	No	
23.	Situation of slums during the rainy season?	Accumulation of water	Water is logged completely.
24.	No. of out of school children	08 (Age group 8 - 19)	Female - 04 & Male - 04
25.	No. of Person with disability	06 People	Locomotor Disability Leg, Mental Health and Speech Impairment
26.	No. of Sanitation Workers	7	
<b>Sanitation</b>			
27.	Status of Door-to-door collection	Daily collection done through E-cart and Hand cart between 6 am - 11am	Anup Kumar, Mob - 9162815903
28.	Status of brooming	Processing	Issue has been escalated to respective City Manager & CSI.



## Existing gaps in the slum at the infrastructure level

Sr. No.	Status of Infrastructure services	Numbers	Current status	Work needs to be done
1.	Road	4	Minor damaged	Maintenance work
2.	Street	4	Minor damaged	Construction required
3.	Public Toilet	3	3 is working	Clean and maintenance work required
4.	Drainage	1	1 main drainage	Cleaning work is required
5.	Street Light	8	No Functional	Need to repair
6.	Water supply	4 Borewells	functional	Pipeline connection and proper platform for bathing space is required
7.	Earthwork	Filling and leveling of land are needed near the railway track ground		Filling & Levelling, converted into a dumping point, needs to be clean.
8.	Hand pump	04	03 Non-Functional	Need to repair

2	<b>Social Capital</b>	
1	Youth Collective	30 Members
2	Women Collective	20 Members
3	SHG under NULM	Doesn't exist
4	Monitoring Committee	1 group consisting of 5 members
5	Social Action/Leadership: Discussion with collectives on social issues like Gender based violence, Child marriage, visioning in slums, Health, Sexual & reproductive health rights, Menstrual health and hygiene etc.	
3	<b>Strengthen Health</b>	
1	Aware people regarding role of UPHCs/ASHA/AWC	In Process
2	Health/Vaccination camps: Health camps need to be organized on Monthly basis.	In Process

## Development Plan:

### Toilet:

Sr. No	Type of toilet	Seat	Issue	Remarks
1.	Community	5	Cleaning work and maintenance is required, water tap is required to be replaced. There is muddy place in front of the toilet.	HH covered: 100 (Appx Population: 500 covered). Current Load on toilet: 50 people per seat. <b>Requirement: 40 seats</b>
2.	Community	8	Currently in use, Maintenance is average. Taps are working. Outside 2 wash basins are broken, taps are not working.	HH covered: 100 (Appx Population: 500 covered). Current Load on toilet: 50 people per seat. <b>Requirement: 40 seats</b>
3.	Community	10	This is not functional; the toilet is completely in poor condition. Need to be constructed in a new form.	HH covered: 150 (Appx Population: 750 covered). Current Load on toilet: 75 people per seat. <b>Requirement: 37 seats</b>

**Note:** Total number of toilets has **23 seats**. The load over one seat is around **58** people. Seeing this there is a need of around **117 seats at present**.

### Action Required for above - mentioned toilet issues:

- Regular cleaning process required.
- Taps need to be repaired.
- Local community person needs to be appointed for the maintenance.
- Community awareness as the social capital should be raised to pay for the maintenance.
- Generate social awareness among the community with the help of our collectives. Need a strong effective session.



8-seater community toilet



10-seater community toilet



5-seater community toilet

### Open Space:

There is an empty land in mid of the slum. Last year on the commissioner visit this empty land was selected for the construction of the community toilet. The foundation work and chamber of the toilet is constructed for 4-seater but the work is stop now due to contractual issues. This need to be construct for the slum that covers around 50 HH.



### Drainage Blockage:

In Kaushal Nagger slum the main drainage is very muddy and full of waste, the dirty water of the drainage running above it, community people are facing trouble due to waterlogging and bad smells. It is also dangerous for the young children playing around.



Sr. No.	Issue	Action Required
1.	The main drainage of the slum is blocked by throwing the garbage	Need to be cleaned on regular basis to avoid blockage
2.	The door-to-door vehicle not able to visit in the street	Need to place a big dustbin in the slum
3.	Waste dumping	Strict messages for the fine are to print and stick on the main locations of the slum.

### Water Resources:

People have to fetch the water through borewells far from the houses for daily chores. The pipeline supply is in process, but the borewells is important for the slum. Currently Borewells are only the source of water.



### Recommendation:

- Toilets need to be clean and maintenance works is needed.
- The Borewell base platform needs to be repaired, broken due to water logging. Need to be construct platform for bathing.
- Main drainage needs to be clean on regular basis and boundary wall is required as the depth of the drain is deep.
- Uneven land of the slum needs to be filled to avoid the water logging.
- Handpumps need to repair as summer is already came.
- Waste collection needs to be collected door to door and brooming needs to be done on a daily basis. Dustbins are needed for the slum.



## SLUM DEVELOPMENT PLAN



**R - Block, Ward - 21**  
New Capital Circle (NCC)



## Background of the Slum

R Block slum is situated since the early 1980s at behind the PF office and hotel Chankya Patna. There are about 300 households and people from Hindu and Muslim community, mostly people are from SC and OBC category. This community is having population of about more than 1200. Most of the people residing here are Government employee, employed in private jobs, pavement shopkeeper and daily wagers.

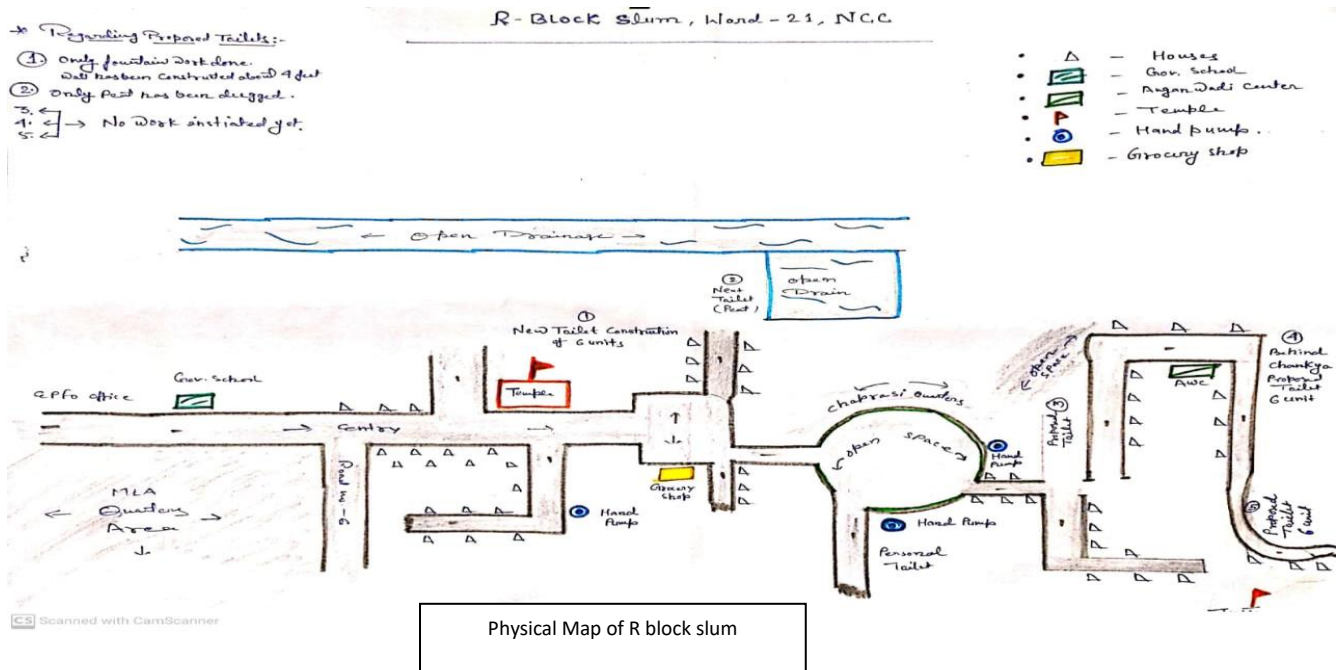

For primary education there is one AWC and one primary school near the slum. The children of the community go to Govt. Middle School and Miller High School for further studies. It is about 200 meters from the slum. People of the community go to the New Gardnibagh Hospital, about 500 meters from the slum, in case of any health-related issues. There is only one bore well just outside the slum and there are three hand pumps from where people use to collect water for daily use. There is not any street light or solar light in the slum. People are using their own connections to light the street during night. Water logging is also a problem in this slum, there are few streets which gets logged for days and people have to cross it to reach their houses.

## Structure of the Development Plan

The plan discusses the current situation of the slums. It combines the crucial information on Demography, physical infrastructure, health and slum dynamics and sanitation indicators. The information is crucial to set up the baseline of the development plan. In the subsequent sections the plan discusses about the gap which is visible for a more robust and inclusive services for the development plan. The gap focuses on infrastructure services, social capital and strengthening the health services. The last section explicitly focuses on the intervention plans supported by the photographs. The drainage blockage and community toilets are intrinsic part of the current intervention strategy for the project.

### Current Status at a Glance (SLUM):

Sr. No.	PARTICULAR	SPECIFICATION	REMARKS
<b>Demography of the slum</b>			
27.	Nearest Landmark	Behind Hotel Chankya	
28.	Total Household	300 Approx.	
29.	Total Population	1200	
30.	Majority- Caste wise/Religion wise	SC (Harijan), OBC	
31.	Male	550 Approx.	Source: ward councilor
32.	Female	475 Approx.	
<b>Physical Infrastructure of the slum</b>			
33.	Open Space in slum, if yes then how many	Yes	One
34.	No. of Community toilet	1	Non-Functional
35.	No. of total units/seats	3	Details provided in the next page.
36.	Community toilet run by whom? -	PMC	
37.	Number of bore well	1	
38.	Number of functional bore wells	1	
39.	Number of hand pump	1	
40.	Number of functional hand pump	1	
41.	No. of street lights	05	Installation Needed
42.	Nearest Aanganwadi Centre (Distance from slum)	1 Anganwadi is in the slum	Functional
<b>Health</b>			
43.	Nearest PHC (Distance from Slum)	UPHC Gardanibagh 500 m, Gardanibagh District Hospital	
44.	Nearest Govt. School (Distance from slum)	1 Government school in the slum	Primary school, Gardanibagh
45.	Is there Asha worker in the slum/Ward	No	
<b>Slum dynamics</b>			
46.	Major occupation of people living in the slum	Daily wager, sanitation worker, Shopkeeper and rag picker	
47.	Is there concrete road in the slum	No	
48.	Is there proper drainage system in the slum	No	
49.	Situation of slums during the rainy season?	Accumulation of water	Water is logged completely.
50.	No. of out of school children	15 (Age group 8 - 19)	Female - 09 & Male - 04
51.	No. of Person with disability	02 People	Speech Impairment
52.	No. of Sanitation Workers	6	Working with PMC
<b>Sanitation</b>			
27.	Status of Door-to-door collection	Daily collection done through E-cart and Hand cart between 6 am - 11am	Raju Kumar, Mob - 9570804437
28.	Status of brooming	Processing	

## Existing gaps in the slum at the infrastructure level:

Sr. No.	Status of Infrastructure services	Numbers	Current status	Work needs to be done
9.	Road	1	Damaged	Maintenance work
10	Street	1	Construction required	Construction required
11	Public Toilet	1	Non-Functional	Water and electricity connection is need to be done
12	Drainage	1	Raw drainage	Need to be construct & Cleaning work is required
13	Street Light	5	Non-Functional	Installation needed
14	Water supply	1 Borewells	functional	Pipeline connection is required for every houses
15	Earthwork	Filling and leveling of land are needed near the railway track ground		Filling & Levelling, converted into a dumping point, needs to be clean.
16	Hand pump	4	Required	4 Hand pump required in the slum

<b>2.</b>	<b>Social Capital</b>	
1.	Youth Collective	30 Members
2.	Women Collective	20 Members
3.	SHG under NULM	Doesn't exist
4.	Monitoring Committee	1 group consisting of 5 members
5.	Social Action/Leadership: Discussion with collectives on social issues like Gender based violence, Child marriage, visioning in slums, Health, Sexual & reproductive health rights, Menstrual health and hygiene etc.	
<b>3.</b>	<b>Strengthen Health</b>	
1.	Aware people regarding role of UPHCs/ASHA/AWC	In Process
2.	Health/Vaccination camps: Health camps need to be organized on Monthly basis.	In Process

## Development Plan:

### Toilet:

Sr. No	Type of toilet	Seat	Issue	Remarks
1.	Community	3	Not functional currently. The electricity and water supply has been not connected.	HH covered: 100 (Appx Population: 500 covered). Current Load on toilet: 50 people per seat. <b>Requirement: 52 seats</b>

**Note:** Total number of toilets has **03 seats**. The load over one seat is around **50** people. Seeing this there is a need of around **117 seats at present**.

### Action Required for above mentioned toilet issues:

- Connection of water and electricity on urgent basis.
- Construction of more toilets on the visited place
- Construction of toilet need to be complete where it initiated in the slum.

- Community awareness as the social capital should be raised to pay for the maintenance.
- Generate social awareness among the community with the help of our collectives. Need a strong effective session.



Location for toilet construction



02-seater community toilet under construction



3-seater community toilet

### Blockage of drainage:

There is no proper drainage system exist in the slum, people made themselves raw drainages that produces huge mud and waste that block the main drainage. community people are facing trouble due to waterlogging and bad smells. It is also dangerous for the young children playing around.



Sr. No.	Issue	Action Required
1.	The main drainage of the slum is blocked by throwing the garbage	Need to be clean on regular basis to avoid blockage
2.	The door-to-door vehicle not able to visit in the street	Need to place a big dustbin in the slum
3.	Waste dumping	Strict messages for the fine are to print and stick on the main locations of the slum.



## Water Resources:

There is a need for installation of tap water in every house. Females have to fetch the water through borewells far from the houses for daily chores.



## Open Space:

There is an empty land near the Anganwadi center. Last year on the commissioner visit this empty land was selected for the construction of the community toilet. There is also provisions for the making park.



## Recommendation:

- Toilets need to be repaired on urgent basis, especially the community toilet.
- Completion of foundation work of toilet initiated last year.
- The Borewell base platform needs to be repaired, broken due to water logging.
- Uneven land of the slum needs to be filled to avoid the water logging.
- In the open space construction of park or community toilet can be provisioned.
- Installation of hand pump and street lights in needed.
- Construction of street road from the Chankya hotel side is needed on urgent basis.
- Waste collection needs to be collected door to door and brooming needs to be done on a daily basis. Dustbins are needed for the slum.

## SLUM DEVELOPMENT PLAN



### **Adalat Ganj**

Ward – 21, NCC

## Background of the Slum

Adalat Ganj slum situated in mid of the Patna near Central Water Board head office Patna, the slum was formed in early 1980s. The slum is divided into four Mohalla's on the division of caste and work type: Einkh Mohalla, Drivers Mohalla, Kedar Mohalla and Harijan Mohalla. The total number of households in this slum is around 1200 and the population of this slum is approximately 4000. There are four entry points of this slum as each tola has a different entry point. The population of Adalat Ganj comprises different castes like: Manjhi, Kahar, Dom, Vishwakarma, Mandal and Mehtar. Majority of the population from this basti works as housekeeping staff in hotels

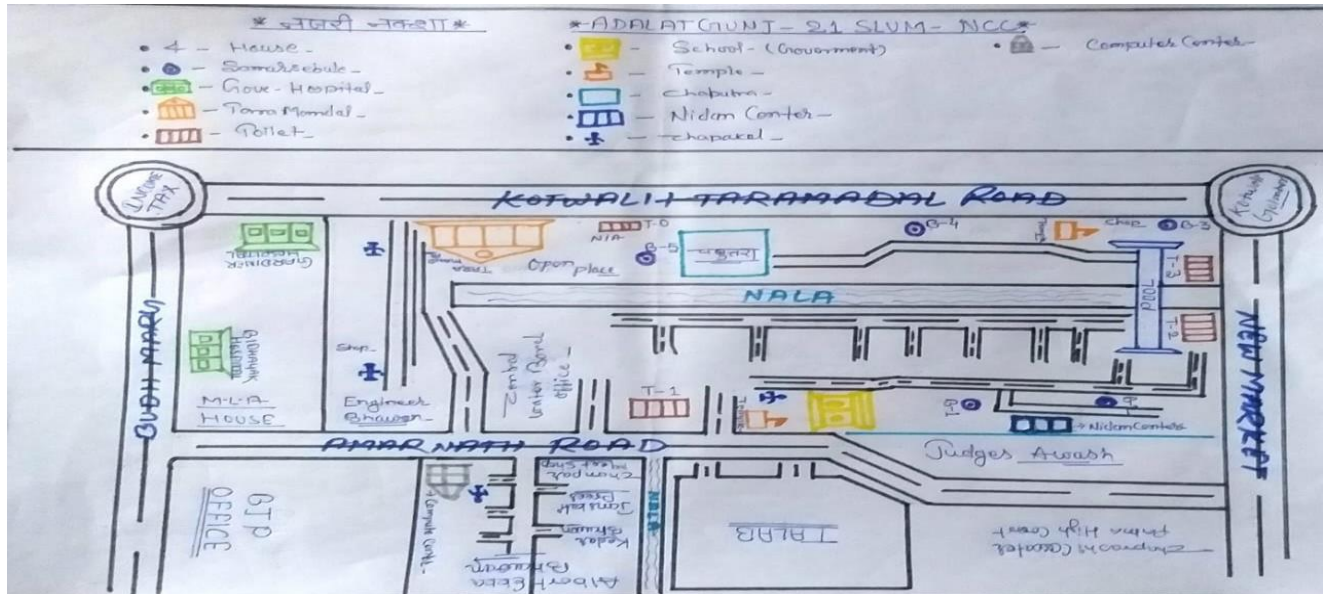

and malls. Many women from this slum are working as house maids. There are a good number of people also engaged in driving, also people do seasonal business-like selling sugarcane juice in summer. There are two Aanganwadi centers located in two different Mohalla: One is in driver's Mohalla and Other one is in harijan Mohalla. There are 30 children enrolled in each Aanganwadi center. There are 30 children enrolled in each Aanganwadi center. Nearest hospital from basti is new **Gardiner hospital** which is about 1 Km from the basti. People do visit IGIMS and PMCH too for treatments. There is a primary school which is in Harijan Tola. Middle and high schools are about 1 Km from the basti. For higher education, students go to these schools. Two bore wells are there but more bore wells are required considering the population size of the slum. Though few households have their personal hand pump. There is a paid community toilet but this is not enough to cater the needs of the slum. There were two modular toilets with 6 seats each set up by Tata foundation on either side of open drainage. These toilets were not functional as water connection was not done after installation of toilet units. The main drainage goes along with the slum that is very deep and dirty. It needs to be cleaned on a regular basis. There is no boundary given in the drainage so it is also very risky for the people and the children as it is just beside the slum.

## Structure of the Development Plan

The plan discusses the current situation of the slums. It combines the crucial information on Demography, physical infrastructure, health and slum dynamics and sanitation indicators. The information is crucial to set up the baseline of the development plan. In the subsequent sections the plan discusses the gap which is visible for more robust and inclusive services for the development plan. The gap focuses on infrastructure services, social capital and strengthening the health services. The last section explicitly focuses on the intervention plans supported by the photographs. The drainage blockage and community toilets are intrinsic part of the current intervention strategy for the project.



## Current Status at a Glance (SLUM):

Sr No.	Indications	Current Status	Remarks
<b>Demography</b>			
1.	Landmark	Central Water Board	
2.	Total Household	800	
3.	Total Population	3700	
4.	Majority- Caste wise/Religion wise	Harijan (Mehtar, Paswan)	
5.	Male	1950	Source: ward councilor
6.	Female	1750	
<b>Physical Infrastructure</b>			
7.	Open Space in slum, if yes then how many	1	Near the driver's colony
8.	No. of Community toilet	3	Functional: 3
9.	No. of total units/seats	24	Details provided in the next page.
10.	Community toilet run by whom? -	PMC	3 Toilet run by PMC
11.	Number of bore wells	7	
12.	Number of functional bore wells	6	1 is non functional
13.	Number of hand pump	1	Non-Functional
14.	Number of functional hand pump	0	
15.	No. of street lights	31	18 are Non functional
<b>Health</b>			
16.	Nearest Anganwadi Center (Distance from slum)	2 Anganwadi is in the slum	Functional
17.	Nearest PHC (Distance from Slum)	250m	Name: New Gardiner Hospital
18.	Nearest Govt. School (Distance from slum)	1 Government school is in the slum	Primary school, Adalat Ganj
19.	Is there Asha worker in the slum/Ward	N/A	
<b>Slum Dynamics</b>			
20.	Major occupation of people living in the slum	Driving and sugarcane business	
21.	Is there concrete road in the slum	Yes, the roads here are paved and concrete, except for one street.	Currently many roads are damaged due to the setting of the water supplies pipeline.
22.	Is there proper drainage system in the slum	No	
23.	Situation of slums during the rainy season?	The situation is bad, rain water gets accumulated in people's houses, causing them to face health hazards.	Water is logged completely.
24.	No. of out of school children	15 (Age group 8 - 19)	Female - 7 & Male - 8
25.	No. of Person with Disability	4	Locomotor Disability Leg and Hand, Speech Impairment
26.	No. of Sanitation worker	PMC recruited 12	
<b>Sanitation</b>			

27.	Status of Door-to-door collection	Daily collection done through E-cart and Hand cart between 6 am - 11am	Rakesh Kumar, 7667974702
29	Status of brooming	Initiated now	Issue has been escalated to the City Manager & CSI.

### Existing gaps in the slum at the infrastructure level

Srl No.	Status of Infrastructure services	Numbers	Current status	Work needs to be done
1.	Road	2	Raw (Kaccha)	Concrete/Paver
2.	Street	13	Few are made of concrete but most of the streets are raw and dirty.	Cleaning and levelling then concrete work and Paver work is needed.
3.	Public Toilet	3	3 is functional, but the taps are broken and the seats are very dirty.	Water connection damaged in 1 toilet needs to be repaired.
4.	Drainage	14	1 main and 12 sub drainages	Cleaning, repairing
5.	Street Light	31	8 is not working	Repair work is needed
6.	Water supply	700 HH	Piping work is done water supplies has not started yet in every HH	Measurement, Pipeline connection is required
7.	Earthwork	Beside the Main Drainage	Open and damaged	Levelling
8.	Hand pump	1	Non functional	Need to repair

Social Capital		
1.	Youth Collective	30 Members
2.	Women Collective	20 Members
3.	SHG under NULM	Doesn't exist
4.	Monitoring Committee	1 group consisting of 5 people
5.	Social Action/Leadership: Discussion with collectives on social issues like Gender based violence, Child marriage, visioning in slums, Health, Sexual & reproductive health rights, Menstrual health and hygiene etc.	
Strengthen Health		
1.	Aware people regarding role of UPHCs/ASHA/AWC	In Process
2.	Health/Vaccination camps: Health camps need to be organized on Monthly basis.	In Process

## Development Plan

### Toilet:

S. No.	Type of toilet	Seat	Issue	Remarks
1.	Community	12	There is no street light in the toilet or nearby, it is difficult to go in the dark. One of the members of the community has placed a bulb there. Wall is getting rough and damp.	HH covered: 150 (Appx Population: 750 covered). Current Load on toilet: 75 people per seat. <b>Requirement: 63 seats</b>
2.	Modular	6	Toilet seats are very dirty. Poor maintenance, tap is leaking.	HH covered:50 (Appx Population: 250 covered). Current Load on toilet: 25 people per seat. <b>Requirement: 19 seats</b>
3.	Modular	6	Seats are very dirty and jammed, poor maintenance. Many inside taps are broken. Outside taps of the wash basin are broken. Surrounding of the toilet is also very dirty.	HH covered:50 (Appx Population: 250 covered). Current Load on toilet: 25 people per seat. <b>Requirement: 19 seats</b>

**Note:** Total community toilets have **24 seats** in the slum, on each seat there is a load of around 40 people. So, there is a need for at least **100 more toilet seats**, seeing the availability of land people having personal toilets.

### Action Required in above - mentioned toilet issues:

- Regular cleaning process required.
- Taps need to be repaired.
- Local community person needs to be appointed for the maintenance.
- Community awareness as the social capital should be raised to pay for the maintenance.
- Generate social awareness among the community with the help of our collectives. Need a strong effective session.





## Blockage of street:

Sr. No.	Issue	Action Required
1.	The main street that connects the slum to the main road is blocked by garbage thrown. Streets are also damaged due to installation of water pipelines in the community	<ul style="list-style-type: none"> <li>Need land filling, levelling &amp; paving.</li> <li>Paver road should be constructed here.</li> </ul>
2.	The door-to-door vehicle is not able to enter the community.	Need to place a big dustbin on the crossroad
3.	Garbage thrown by the people	Strict messages for the fine are to be printed and stick to every main location of the slum.

## Drainage Blockage:



Sr. No.	Issue	Action Required
1.	Blockage of drainage	Need to clean regular basis
2.	Broken drainage	Need to repair main drainages of the slums
3.	Gathering of garbage	Collection of garbage on regular basis from the slum
4.	Garbage thrown by the people	Strict messages for the fine is to print and stick in every main location of the slum.

## Open space:



Sr. No.	Issue	Action Required
1	There is empty land in the driver's colony. There is a concrete platform made up, people generally do the meetings here only, but there is no shading and boundary, there is no electricity support nearby it.	<ul style="list-style-type: none"> <li>Shading and boundary wall</li> <li>Plantation is needed.</li> <li>Suggestion from the community - The space should be used as a community hall or just made a shade where community gathering may be organize.</li> </ul>

## Water Resources:



Sr. No.	Issue	Action Required
1.	New water pipeline is installed in the slum, but that is not in the proper way. During the installation it damaged the previous supply line.	Maintenance work need to be done of the streets damaged during pipe line work
2.	One street in the new Ambedkar colony has not got pipeline supply.	A supply line needs to be installed in the street.
3.	One handpump is non functional	Need to be repair

## Waste Management:



Sr. No.	Issue	Action Required
1.	Accumulation of garbage	Need Big Dustbins separate for Dry/wet waste
2.	Not proper location for waste dumping	Provisioning of dustbin
3.	Irregular Door to door vehicle	Regular door to door waste collection needs to be provision
4.	Garbage thrown by the people in open space	Provision of door-to-door waste collection to be done

---

## Recommendation:

- Drainages need to be clean and reconstruct as per need
- Chambers of the main drainages need to be cleaned.
- Toilets are need to be clean and repair the broken accessories
- Behind the area of the toilet in the old Ambedkar colony needs to be filled with soil and make even land. This is the dirtiest part of the slum, we can think about the construction of a small park/community hall etc.
- In this area of the toilet one street light is also needed.
- The community hall in the new Ambedkar colony needs to be repaired and painted.
- Installation of big dustbins is needed in the slum.
- Waste collection from door to door and brooming is needed on a daily basis.



# SLUM DEVELOPMENT PLAN



**Baaskothi, Ward – 22A**

Patliputra Circle

## Background of the Slum

Baas Kothi slum is situated in gate no. 93, ward 22A of Patliputra circle in between the Digha - Kurjee road and bank of Ganga, this slum was formed in early 1980s. There are about **300 households** and people from castes SC & ST (Harijan). This slum is settled on government land. The population of this slum is more than 1500. Mostly people residing here indulge in professions like labor on daily wages, few work as a vendor in the market, house maid and in rag picking.

There is one Anganwadi Centre (AWC) nearby the slum and 30 children are enrolled in each of them. The Anganwadi Centre is not active at present due to the corona pandemic. There is a middle school (*Madhyamik Vidyalaya*) nearby the slum, where children from slum go for their primary education. But still many children are not enrolled in school. For medical facilities people visit the Health & Wellness center in the slum and UPHC at Digha is about 500 meters from the community

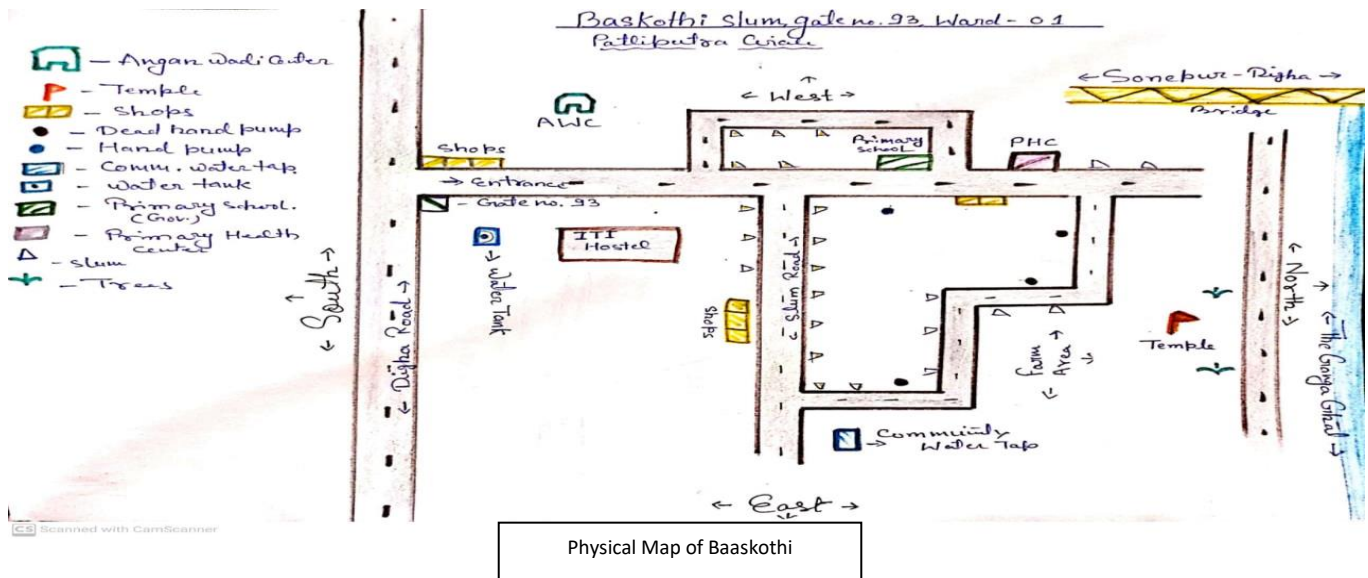

There are one bore wells, one is having a tank with it. But it's not enough for the community, as it is highly populated. There is no proper bathing space, women and girls have to take baths in open space.

Drainage and sanitation are a big issue for this slum. There are few chambers in Shivaji Path which are not connected and because of this water does not flow from the drains, and this creates a problem of water logging. During the rainy season this slum becomes flooded.

## Structure of the Development Plan

The plan discusses the current situation of the slums. It combines the crucial information on Demography, physical infrastructure, health and slum dynamics and sanitation indicators. The information is crucial to set up the baseline of the development plan. In the subsequent sections the plan discusses about the gap which is visible for a more robust and inclusive services for the development plan. The gap focuses on infrastructure services, social capital and strengthening the health services. The last section explicitly focuses on the intervention plans supported by the photographs. The drainage blockage and community toilets are intrinsic part of the current intervention strategy for the project.

## Current Status at a Glance (SLUM):

Sr. No.	Indications	Current Status	REMARKS
<b>Demography</b>			
1.	Nearest Landmark	Gate no. 93	Digha - Kurjee road
2.	Total Household	300 Approx.	
3.	Total Population	1500	
4.	Majority- Caste wise/Religion wise	SC (Harijan) & OBC	
5.	Male	750Approx.	Source: ward councilor
6.	Female	650 Approx.	
<b>Physical Infrastructure</b>			
7.	Open Space in slum, if yes then how many	Yes	
8.	No. of Community toilet	N/A	
9.	No. of total units/seats	N/A	
10.	Community toilet run by whom? -	N/A	
11.	Number of bore well in the slum	1	
12.	Number of functional bore wells	1	
13.	Number of hand pump	2	
14.	Number of functional hand pump	1	
15.	No. of street lights in the slums	20	11 (non-functional)
16.	Nearest Aanganwadi Centre (Distance from slum)	1	Functional
<b>Health</b>			
17.	Nearest PHC (Distance from Slum)	UPHC Digha, 500 m	
18.	Nearest Govt. School (Distance from slum)	1 Government school in the slum	Middle school, Baskothi
19.	Is there Asha worker in the slum/Ward	No	
<b>Slum dynamics</b>			
20.	Major occupation of people living in the slum	Daily wager Labor, Market vendor	
21.	Is there concrete road in the slum	Yes	(Only few street)
22.	Is there proper drainage system in the slum	Yes	Not functional
23.	Situation of slums during the rainy season?	Accumulation of water	Water is logged completely.
24.	No. of out of school children	06 (Age group 12 - 16)	Female - 03 & Male - 03
	No. of Person with disability	02 People	Locomotor Disability (Leg)
25.	No. of Sanitation Workers	02 SW of PMC	
<b>Sanitation</b>			
27.	Status of Door-to-door collection	Daily collection done through E-cart and Hand cart between 6 am - 11am	Dilip Kumar, Mob - 8864090588
28.	Status of brooming	In process	



## Existing gaps in the slum at the infrastructure level:

Sr. No.	Status of Infrastructure services	Numbers	Current status	Work needs to be done
1.	Road	1	Damaged	Maintenance work
2.	Street	4	Construction required	Construction required
3.	Public Toilet	N/A		
4.	Drainage	1	1 main drainage	Cleaning work is required
5.	Street Light	11		Need to repair
6.	Water supply	1 Borewell	Functional	Pipeline connection is required
7.	Earthwork	Filling and leveling of land are needed near the railway track ground		Filling & Levelling, converted into a dumping point, needs to be clean.
8.	Hand pump	1	Non functional	Need to repair, 4 more hand pumps required

<b>2</b>	<b>Social Capital</b>	
1	Youth Collective	30 Members
2	Women Collective	20 Members
3	SHG under NULM	Doesn't exist
4	Monitoring Committee	1 group consisting of 5 members
5	Social Action/Leadership: Discussion with collectives on social issues like Gender based violence, Child marriage, visioning in slums, Health, Sexual & reproductive health rights, Menstrual health and hygiene etc.	
<b>3</b>	<b>Strengthen Health</b>	
1	Aware people regarding role of UPHCs/ASHA/AWC	In Process
2	Health/Vaccination camps: Health camps need to be organized on Monthly basis.	In Process

## Development Plan:

### Toilet:

Sr. No	Type of toilet	Seat	Issue	Remarks
1.	Community	0	There is no community or Modular toilet in the slum, people used to use it for open defecation near the bank of Ganga River. Some people have their personal temporary toilet.	HH: 300 Population: 1500 <b>Requirement: 150 seats</b>

**Note:** There are 150 seats required for the slum as per the current situation.

### Action Required for above mentioned toilet issues:

- In the PMC commissioner it has been decided to construct a community toilet in the available space near the bank of the river side.



## Drainage Blockage:

In the slum the manholes are completely blocked, the dirty water of the drainage running above it, community people are facing trouble due to waterlogging and bad smells. It is also dangerous for the small children playing around.

Sr. No.	Issue	Action Required
1.	The main drainage of the slum is blocked by throwing the garbage	Need to be clean on regular basis to avoid blockage
2.	The door-to-door vehicle not able to visit in the street	Need to place a big dustbin in the slum
3.	Waste dumping	Strict messages for the fine are to print and stick on the main locations of the slum.



## Water Resources:

There is a need for installation of tap water in every house. Females have to fetch the water through borewells far from the houses for daily chores.





---

## Hand Pump:

The hand pumps are in need of repair as there are limited sources of water.



## Open Space:

There is an empty land near the bank of Ganga River and Gaushala. Last year on the commissioner visit this empty land was selected for the construction of the community toilet.



for

## Recommendation:

- Toilets need to be constructed in the slum in the available space.
- Hand pumps are needed to repair on an urgent basis, and installation of 4 more handpumps to be provisioned.
- Uneven land of the slum needs to be filled to avoid the water logging.
- The underground drainage in the slum needs to be cleaned to avoid the blockage.
- Street lights need to be repaired.
- Main roads and streets need to be constructed to avoid water logging.
- Waste collection needs to be collected door to door and brooming needs to be done on a daily basis. Dustbins are needed for the slum.



# SLUM DEVELOPMENT PLAN



## Shastrinagar PWD, Ward - 08

Patliputra Circle

## Background of the Slum

Shastri Nagar slum is situated in ward 08 of Patliputra circle opposite the Rajbanshi nagger hospital; this slum was formed early in the 1975s. Many people have been living here since their childhood. There are four entrances to the slum. About **350 households** and people from castes like SC & ST (Harijan, Dom and Mushahar). This slum is settled on government land. The population of this slum is more than 2500. Most people here indulge in professions like sanitation work (Privately), few work for Nigam, and few as market food and vegetable vendors. Women are mainly working as housemaids. There are 2 Anganwadi Centres (AWC) in the slum, and 30 children are enrolled in each of them. These Anganwadi centres are not active at present due to the corona pandemic. There is a middle and high school (*Madhyamik Vidyalaya*) nearby the slum, where children from the slum go for their education. But still, many children are not enrolled in school. For medical facilities, people visit Rajbanshi Nagar (LNJPN)

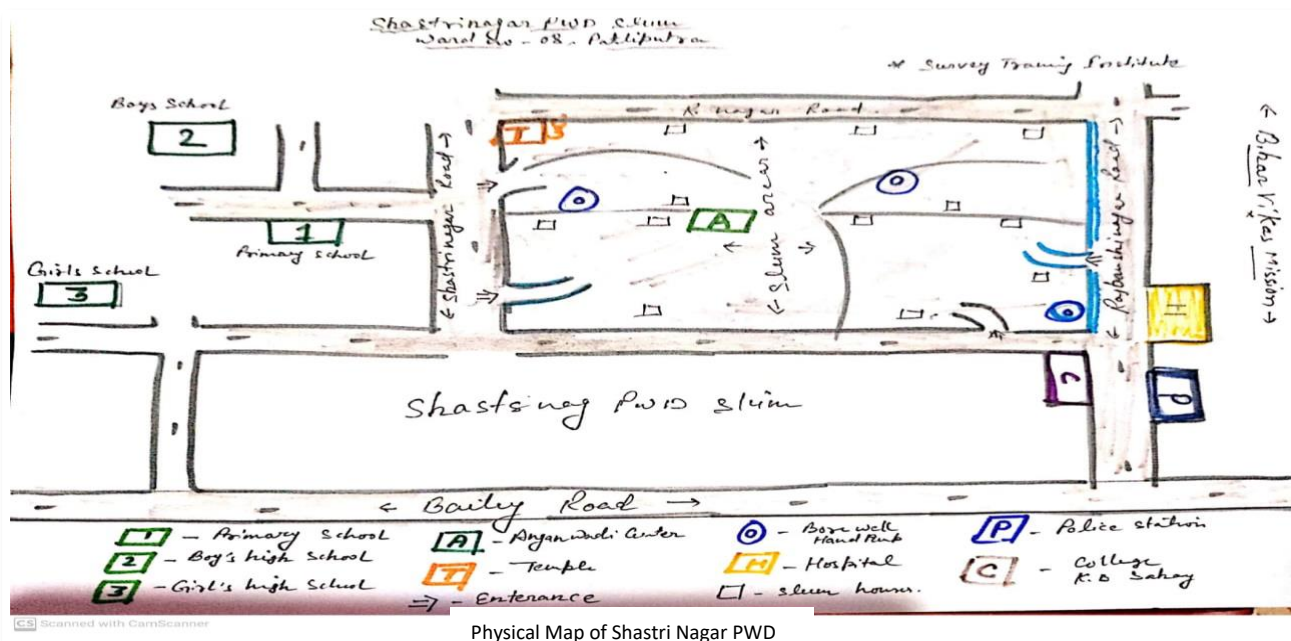

District Hospital just beside the community. The UPHC of the slum is situated a little far from the slum. There are 17 bore wells installed for the 17 newly constructed toilets. There is no proper bathing space; women and girls have to take baths in open spaces. Drainage and sanitation are significant issues for this slum. There are no drainage system and the chamber to resolve this issue. It is also not connected, and because of this, water does not flow from the drains, which creates a problem of waterlogging. During the rainy season, this slum becomes flooded.

## Structure of the Development Plan

The plan discusses the current situation of the slums. It combines the crucial information on Demography, physical infrastructure, health and slum dynamics and sanitation indicators. The information is crucial to set up the baseline of the development plan. In the subsequent sections the plan discusses about the gap which is visible for a more robust and inclusive services for the development plan. The gap focuses on infrastructure services, social capital and strengthening the health services. The last section explicitly focuses on the intervention plans supported by the photographs. The drainage blockage and community toilets are intrinsic part of the current intervention strategy for the project.

## Current Status at a Glance (SLUM):

Sr. No.	Indications	Current Status	Remarks
<b>Demography</b>			
53.	Landmark to the slum	LNJPN Hospital	Rajbanshi Nagar
54.	Total Households	350 <sub>app</sub>	
55.	Total Population	2500	
56.	The majority- Caste wise/Religion wise	SC (Harijan)	
57.	Male	1150 <sub>app</sub>	Source: ward councillor
58.	Female	1050 <sub>app</sub>	
<b>Physical Infrastructure</b>			
59.	Open Space in the slum, if yes, then (Nos.)	Yes	
60.	No. of Community toilets	17	Two are Functional
61.	No. of total units/seats	152	Details are provided on the next page.
62.	Community toilets	Yes	Run by PMC
63.	No. of bore wells	17	
64.	No. of functional bore wells	17	
65.	No. of hand pumps	4	
66.	No. of functional hand pumps	2	
67.	No. of street lights	N/A	
68.	No. of Aanganwadi Centre	2	Functional
<b>Health</b>			
69.	Nearest PHC (Distance from Slum)	UPHC Shastri Nagar 1km, LNJPN District Hospital	
70.	Nearest Govt. The school (Distance from the slum)	2 Government schools nearby the slum	Middle and high school for boys and girls,
71.	Is there an Asha worker in the slum/Ward	No	
<b>Slum dynamics</b>			
72.	Primary occupation of Slum Households	Daily wager, Mason and vendors	
73.	A concrete road in the slum	No	
74.	Proper drainage system	No	
75.	The situation of slums during the rainy season?	Accumulation of water	Water is logged completely.
76.	No. of out of school children	16 (Age group 8 - 19)	Female - 05 & Male - 11
77.	No. of Person with disability	12 People	Locomotor disability Leg & Hand, Speech & hearing impairment
78.	No. of Sanitation Workers	06 SW of PMC	
<b>Sanitation</b>			
27.	Status of Door-to-door collection	Daily collection is done through E-cart and Hand cart between 6 am - 11 am	Md. Firoz, Mob - 9931972572
28.	Status of brooming	In process	



## Existing gaps in the slum at the infrastructure level:

Sr. No.	Status of Infrastructure Services	Numbers	Current status	Work needs to be done
17	Road	02	Damaged	Maintenance work
18	Street	12	Construction required	Construction required
19	Public Toilet	15	Non-Functional	2 are functional
20	Drainage	1	1 main drainage	Cleaning work is required
21	Streetlight	0		Installation needed
22	Water supply	17 Borewells	Functional	
23	Earthwork	Filling and levelling of land are needed near the railway track ground		Filling & Levelling, converted into a dumping point, needs to be clean.
24	Hand pump	0	Required	4 Hand pumps required in the slum

<b>2.</b>	<b>Social Capital</b>	
1.	Youth Collective	30 Members
2.	Women Collective	20 Members
3.	SHG under NULM	Doesn't exist
4.	Monitoring Committee	1 group consisting of 5 members
5.	Social Action/Leadership: Discussion with collectives on social issues like Gender-based violence, Child marriage, visioning in slums, Health, Sexual & reproductive health rights, Menstrual health and hygiene etc.	
<b>3.</b>	<b>Strengthen Health</b>	
1.	Aware people regarding the role of UPHCs/ASHA/AWC	In Process
2.	Health/Vaccination camps: Health camps need to be organized on a Monthly basis.	In Process

## Development Plan:

### Toilet:

Sr. No	Type of toilet	Seat	Issue	Remarks
1.	Community	12	Currently Not Functional. The toilet has been locked for a long time. The community people have no access to use it. Due to poor maintenance, it had been closed by WC.	HH covered: 20 (Appx Population: 100 covered). Current Load on the toilet: 10 people per seat. <b>Requirement: Need to make toilet functional</b>
2.	Community	10	Currently Not Functional. The toilet has been locked for a long time. The community people have no access to use it. Due to poor maintenance, it had been closed by WC.	HH covered: 20 (Appx Population: 100 covered). Current Load on the toilet: 10 people per seat. <b>Requirement: Need to make toilet functional</b>

3.	Community	08	Currently Not Functional. The toilet has been locked for a long time. The community people have no access to use it. Due to poor maintenance, it had been closed by WC.	HH covered: 20 (Appx Population: 100 covered). Current Load on the toilet: 10 people per seat. <b>Requirement: Need to make toilet functional</b>
4.	Community	08	Currently Not Functional. The toilet has been locked for a long time. The community people have no access to use it. Due to poor maintenance, it had been closed by WC.	HH covered: 20 (Appx Population: 100 covered). Current Load on the toilet: 10 people per seat. <b>Requirement: Need to make toilet functional</b>
5.	Community	08	Currently Not Functional. The toilet has been locked for a long time. The community people have no access to use it. Due to poor maintenance, it had been closed by WC.	HH covered: 20 (Appx Population: 100 covered). Current Load on the toilet: 10 people per seat. <b>Requirement: Need to make toilet functional</b>
6.	Community	12	Currently Not Functional. The toilet has been locked for a long time. The community people have no access to use it. Due to poor maintenance, it had been closed by WC.	HH covered: 20 (Appx Population: 100 covered). Current Load on the toilet: 10 people per seat. <b>Requirement: Need to make toilet functional</b>
7.	Community	08	Currently Not Functional. The toilet has been locked for a long time. The community people have no access to use it. Due to poor maintenance, it had been closed by WC.	HH covered: 20 (Appx Population: 100 covered). Current Load on the toilet: 10 people per seat. <b>Requirement: Need to make toilet functional</b>
8.	Community	08	Currently Not Functional. The toilet has been locked for a long time. The community people have no access to use it. Due to poor maintenance, it had been closed by WC.	HH covered: 20 (Appx Population: 100 covered). Current Load on the toilet: 10 people per seat. <b>Requirement: Need to make toilet functional</b>
9.	Community	06	Currently Not Functional. The toilet has been locked for a long time. The community people have no access to use it. Due to poor maintenance, it had been closed by WC.	HH covered: 20 (Appx Population: 100 covered). Current Load on the toilet: 10 people per seat. <b>Requirement: Need to make toilet functional</b>
10.	Community	06	Currently Not Functional. The toilet has been locked for a long time. The community people have no access to use it. Due to poor maintenance, it had been closed by WC.	HH covered: 20 (Appx Population: 100 covered). Current Load on the toilet: 10 people per seat. <b>Requirement: Need to make toilet functional</b>
11.	Community	10	Currently Not Functional. The toilet has been locked for a long time. The community people have no access to use it. Due to poor maintenance, it had been closed by WC.	HH covered: 20 (Appx Population: 100 covered). Current Load on the toilet: 10 people per seat. <b>Requirement: Need to make toilet functional</b>
12.	Community	10	Currently Not Functional. The toilet has been locked for a long time. The community people have no access to use	HH covered: 20 (Appx Population: 100 covered).

			it. Due to poor maintenance, it had been closed by WC.	<i>Current Load on the toilet: 10 people per seat. Requirement: Need to make toilet functional</i>
13 .	Community	12	Currently Not Functional. The toilet has been locked for a long time. The community people have no access to use it. Due to poor maintenance, it had been closed by WC.	<i>HH covered: 20 (Appx Population: 100 covered). Current Load on the toilet: 10 people per seat. Requirement: Need to make toilet functional</i>
14 .	Community	08	Currently Not Functional. The toilet has been locked for a long time. The community people have no access to use it. Due to poor maintenance, it had been closed by WC.	<i>HH covered: 20 (Appx Population: 100 covered). Current Load on the toilet: 10 people per seat. Requirement: Need to make toilet functional</i>
15 .	Community	08	Currently Not Functional. The toilet has been locked for a long time. The community people have no access to use it. Due to poor maintenance, it had been closed by WC.	<i>HH covered: 20 (Appx Population: 100 covered). Current Load on the toilet: 10 people per seat. Requirement: Need to make toilet functional</i>
16 .	Community	08	Functional, people use using according to their needs and lock the toilet.	<i>HH covered: 20 (Appx Population: 100 covered). Current Load on the toilet: 10 people per seat. Requirement: Need to maintain the toilet</i>
17 .	Community	10	Functional, people use using according to their needs and lock the toilet.	<i>HH covered: 20 (Appx Population: 100 covered). Current Load on the toilet: 10 people per seat. Requirement: Need to maintain the toilet</i>

**Note:** Total number of toilets has **152 seats**. The Load over one seat is around **10** people. Seeing this, there is a need to make all the toilets functional for all the slum people.

### Action Required for the above-mentioned toilet issues:

- Resolve the contractual issues and complete the construction work required in the toilets.
- Make functional all the toilets.
- A local community person needs to be appointed for the maintenance.
- Community awareness as the social capital should be raised to pay for the maintenance.
- Generate social awareness among the community with the help of our collectives





8-seater community toilet



10-seater community toilet



08-seater community toilet



8-seater community toilet



8-seater community toilet



8-seater community toilet



8-seater community toilet



6-seater community toilet



8-seater community toilet



6-seater community toilet



10-seater community toilet



12-seater community 3 - toilets



10-seater community toilet



10-seater community toilet



## Drainage Blockage:

The slum is surrounded by the main drainage that is very dirty and full of mud; during the rainy season, the water flows into the slum, and community people face trouble due to waterlogging and bad smells. It is also dangerous for young children to play around.



Sr. No.	Issue	Action Required
1.	The main drainage of the slum is blocked by throwing the garbage	Need to be clean regularly to avoid blockage
2.	The door-to-door vehicle is not able to visit the street	We need to place a big dustbin in the slum
3.	Waste dumping	Strict messages for the fine are to print and stuck on the central locations of the slum.

## Water Resources:

There is a need for the installation of tap water in every house. People have to fetch the water through borewells far from their homes daily. Borewells are functional in the slum. Only pipework is needed.



## Open Space:

There is empty land in the slum. Last year, the commissioner visited this empty land and was selected to construct the community toilet. As there are already several toilets for the community, we can provide for the



---

## Recommendations:

- Toilets need to be repaired and constructed urgently, especially the community toilet; that chamber needs to be reconstructed.
- Drainage needs to be clean on an urgent basis.
- The Borewell base platform needs to be repaired and broken due to waterlogging.
- Street lights need to be installed as the slum is the darkest place.
- The uneven land of the slum needs to be filled to avoid waterlogging.
- Open bathing space needs to be made useful by shading and covering it with boundary walls.
- The waste collection needs to be collected door to door, and brooming needs to be done daily. Dustbins are required for the slum.



## SLUM DEVELOPMENT PLAN



### Nand Nagar

Ward – 48, Bankipore Circle

## Background of the Slum

Nand Nagar colony is situated beside Saidpur Nahar in ward 48 of the Patna Municipal Corporation, in Bankipore circle. The slum has been situated here since the early 1980s. There are almost six hundred households consisting of the Chandravanshi, Paswan, and Yadav communities. The total population of the slum is almost three thousand. Most of the people residing here are either painters or work in other private jobs.

There is one Anganwadi Center (AWC) in the slum. There are 30 children enrolled in Anganwadi Center and 24 children visit it on a daily basis, one primary school, and some private schools in the slum. Almost all houses have private toilets. There is also a Sulabh Shauchalaya in the slum, so people don't feel the need for a community toilet. There is no Primary Health Centre (PHC) in the slum. People visit either

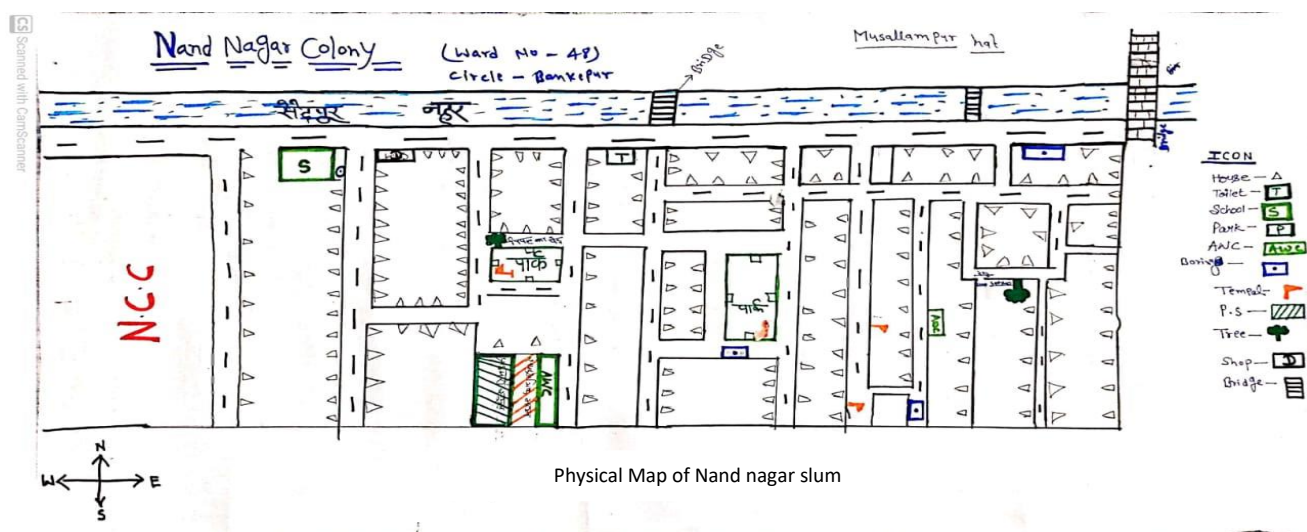

the Rajendra Nagar government hospital or private clinics for their health-related issues.

When there is a serious and emergency situation, people mostly visit Patna Medical College and Hospital (PMCH) that is about 4 kilometers from the slum. In some houses people have installed private borewells but many households are still facing water scarcity. The drainage system of the slum is in very poor condition, as the slum is not leveled there is waterlogging in the slum. There is a pond behind the slum that gets flooded in the rainy season and water enters the houses of community people affecting them on a daily basis. There is only one big drainage in front of the slum that is used for flushing the water from the slum into the main drainage but that is not enough.

## Structure of the Development Plan

The plan discusses the current situation of the slums. It combines the crucial information on Demography, physical infrastructure, health and slum dynamics and sanitation indicators. The information is crucial to set up the baseline of the development plan. In the subsequent sections the plan discusses about the gap which is visible for a more robust and inclusive services for the development plan. The gap focuses on infrastructure services, social capital and strengthening the health services. The last section explicitly focuses on the intervention plans supported by the photographs. The drainage blockage and community toilets are intrinsic part of the current intervention strategy for the project.

## Current Status at a Glance (SLUM):

SRL NO.	PARTICULAR	SPECIFICATION	REMARKS
29.	<b>Demography of slum</b>		
30.	Nearest Landmark to the slum	Saidpur Nahar	
31.	Area in Sq. Feet	272650 Sq ft	
32.	Total Household	580	
33.	Total Population	6000	
34.	Majority- Caste wise/Religion wise	Harijan (Paswan, Chandrawanshi, Dom & Mahto)	
35.	Male	3500	Source: ward councilor
36.	Female	2000	
37.	<b>Physical Infrastructure</b>		
38.	Open Space in slum, if yes then how many	2	
39.	No. of Community toilet	1	Functional
40.	No. of total units/seats	5	For (Male - 3, Female - 2)
41.	Community toilet run by whom?	PMC	
42.	Number of bore well in the slum	1	Big main boring at main road
43.	Number of functional bore wells	1	
44.	Number of hand pump	5	All are out of order
45.	Number of functional hand pump	None	
46.	No. of street lights in the slums	42	Functional
47.	<b>Health</b>		
48.	Nearest Aanganwadi Centre (Distance from slum)	2 Anganwadi is in the slum	Functional
49.	Nearest PHC (Distance from Slum)	2 KM	Name: PMCH
50.	Nearest Govt. School (Distance from slum)	2 Government school is in the slum	Primary & Middle school Nand Nagar
51.	Is there Asha worker in the slum/Ward	1	
52.	<b>Slum Dynamics</b>		
53.	Major occupation of people living in the slum	Most of the people working on daily wages as labor, Vegetable vendor. Some are working in the Patna Municipal Corporation. Female are used to work as house maid in the nearby colonies.	
54.	Is there concrete road in the slum	Yes, the roads here are paved and concrete, except for one street.	Currently many roads are damaged due to setting of the water supplies pipe line.



55.	Is there proper drainage system in the slum	The drainage system of the slum is in very poor condition, as the slum is very low from the main road, the water has stuck in the slum. There is a pond behind the slum that fills in the rainy season and water fill in the slum or in general days too. There is big drainage in front of the slum. There is pump setup in the slum that running for flushing the water from the slum into the main drainage but that is not enough.	1 main drainage need to repair.
56.	Situation of slum during rainy season?	The situation is bad, rain water gets accumulated in people's houses, causing them to face health hazards.	Water is logging completely.
57.	No. of out of school children	7 (Age group 10 - 17)	Female - 04 & Male - 03
58.	No. of Person with Disability	10	Locomotor Disability Leg and Hand, Mental Disability
59.	No. of Sanitation Worker	12	Recruited by PMC
60.	<b>Sanitation</b>		
61.	Status of Door-to-door collection	Daily collection done through E-cart and Hand cart between 6 am - 11am	Dilip Kumar, Mob - 6361901818
62.	Status of brooming	Initiated	Issue has been escalated to respective City Manager & CSI.

<i>Srl No.</i>	<i>Status of Infrastructure services</i>	<i>Numbers</i>	<i>Current status</i>	<i>Work needs to be done</i>
8.	Road	1	Raw (Kaccha)	Concrete/Paver
9.	Street	7	Blocked by throwing waste, water logging & mud	Cleaning and levelling then concrete work and Paver work is needed.
10.	Public Toilet	1	Functional	Water connection damaged in 1 toilet is needed to be repair.
11.	Drainage	1	8 main and 6 sub drainages	Cleaning, repairing
12.	Street Light	42	6 is not working	Need to be repair
13.	Water supply	400 HH got the water supply	Piping work is done water supplies is on hold	Measurement, and 180 HH is still remaining for the piping and connection
14.	CCTV	10 is required		Need for every entrance and are of 2 parks inside of the slum
15.	Earthwork	Required in 2 parks	Uneven & broken	Levelling and filling
16.	Hand pump	5	Out of order	Need to repair

## Existing gaps in the slum at the infrastructure level:

<b>2. Social Capital</b>		
1.	Youth Collective	30 Members
2.	Women Collective	20 Members
3.	SHG under NULM	Doesn't exist
4.	Monitoring Committee	1 group consisting of 5 members
5.	Social Action/Leadership: Discussion with collectives on social issues like Gender based violence, Child marriage, visioning in slums, Health, Sexual & reproductive health rights, Menstrual health and hygiene etc.	
<b>3. Strengthen Health</b>		
1.	Aware people regarding role of UPHCs/ASHA/AWC	In Process
2.	Health/Vaccination camps: Health camps need to be organized on Monthly basis.	In Process

## Development Plan:

### Toilet:

Sr.No.	Type of toilet	Seat	Issue	Remarks
1.	Community	5	Seats and toilet surroundings are very filthy and smelling. No. of seats are very less comparison to the community. There is no any street light in the toilet or nearby, it is difficult to go in the dark.	HH covered: 150 (Appx Population: 750 covered). Current Load on toilet: 75 people per seat. <b>Requirement: 70 seats</b>

**Note:** Total number of toilets is having 05 number of seats. The load over one seat is of around 75 people. Seeing this there is need of around 70 seats at present.

### Action Required for the above-mentioned toilet issues:

- Toilet seats are dirty and very smelly, need to be clean on regular basis.
- Water taps are need to be replace.
- Light is needed near and in the toilet so that people can use it at any time.
- No. of seats need to be increase.



## Drainage Blockage:

Srl No.	Issue	Action Required
1.	Blockage in drainage	Drainage needs to be cleaned on regular basis
2.	8 main drainages are in broken condition	Need to be constructed again
3.	During the water pipeline supply connection, many drainages got damaged	Repair work needs to be done
4.	Throwing garbage by the people in open drainage	Provision of door-to-door waste collection to be done



## Blockage of street:

Sr. No.	Issue	Action Required
1.	The main street that connects slum to the main road is blocked by throwing the garbage and mud.	Needs land to be filling & leveling. Paver road should be construct here. The length of the block street - 200 meters
2.	The door-to-door vehicle not able to visit in the street	Need to place a big dustbin on the crossroad
3.	Throwing garbage by the people	Strict messages for the fine are print and stick every main location of the slum.





## Open Space:

Srl No.	Issue	Action Required
1	The land is empty and extremely dirty and become the storage of garbage and house of pig. It is just behind the slum	<ul style="list-style-type: none"> <li>• Need land filling &amp; leveling.</li> <li>• Plantation is needed.</li> <li>• Suggestion from the community - The area should be fill to prevent from dirty water flowing into the slum</li> </ul>



## Hand Pump:

Srl No.	Issue	Action Required
1.	5 main handpump are out of order and not in use from many months	Need to be repaired





## Supply Water (Pipe Line):

Sr. No.	Issue	Action Required
1.	New water pipeline is installed in the slum, but that is not in proper way, during the installation it also damages the previous supply line.	Maintenance work need to be done of the streets damaged during pipe line work
2.	2 street in Nand Nagar has not got pipeline supply.	Need to be installed supply line in the street called Paswan toli & Chaai Gali.
3.	180 HH still remain from the installation	Installation is needed



## Construction of Park:

Srl No.	Issue	Action Required
1.	2 Empty campus of the community hall is not in use and become the place of waste disposal by community	Need to design and construct a small park with 2 street light. Water sources is available in one park need to repair it only as taps are not working and leaking. There is a water tank need to be shift corner of the park.
2.	Damp and rough compound wall	Wall painting can be done
3.	As there is community hall also, some unsocial elements are misusing the campus	Appointment of a guard after completion of the park and community hall work. Can be done



## Waste Management: Throwing of Garbage

Srl No.	Issue	Action Required
1.	Accumulation of garbage	Need Big Dustbins separate for Dry/wet waste
2.	Not proper location for throwing garbage	Provisioning of dustbin
3.	Irregular Door to door vehicle	Regular door to door waste collection needs to be provision
4.	Throwing garbage by the people open space	Provision of door-to-door waste collection to be done



### Recommendation:

- Need a big drainage system to be establish to flush out the water logging into the main drainage.
- Uneven land of the slum needs to be fill to avoid the water logging
- Both the parks need to construct and repair.
- Drainages need to be clean on regular basis.
- Cleaning of community toilet on regular basis as the amount is taking by the caretaker.
- Waste collection needs to be collected door to door and brooming needs to be done on a daily basis. Dustbins are needed for the slum.



# SLUM DEVELOPMENT PLAN



## Rampur Basti, Ward - 47

Patliputra Circle

## Background of the Slum

Rampur Basti slum is situated in ward 47 of Bankipore circle, this slum was formed early in 1980s. There are about **80 households** and people from castes like SC (Harijan), Paswan and Mahto. This slum is settled on government land. The population of this slum is more than 500. Mostly people residing here indulge in professions like painter, Market vendor, daily wage and selling milk. There are 1 Anganwadi Centre (AWC) in the slum and 30 children are enrolled in each of them, it is little far from the slum so children feel little difficulties to visit there. The Anganwadi Centre's are not active at present due to the corona pandemic. There is a primary school (*Prathmik Vidyalaya*) nearby the slum, where children from slum go for their

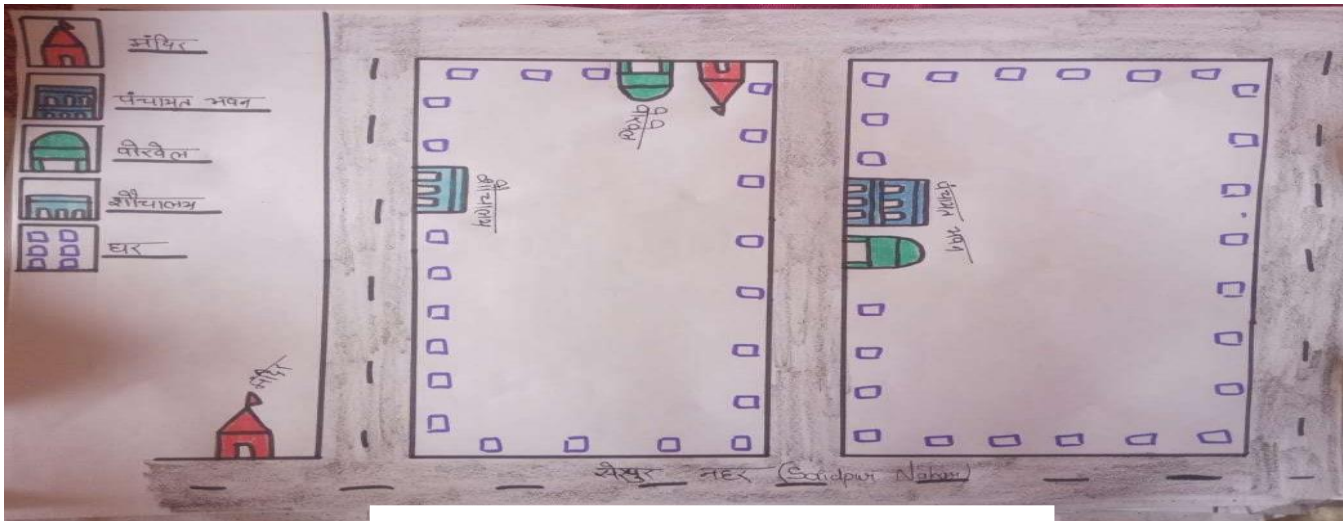

Physical Map of Rampur Basti

primary education. But still many children are not enrolled in school. For medical facilities people visit Sandalpur UPHC which is about 200 meters from the community. Mostly people use to visit the PMCH that is about 2.5 km from the slum. There are one bore wells, one is having a tank with it. But it's not enough for the community, as it is highly populated. Due to the minimal facilities that the community people face a lot of issues such as wastage of water, waiting too long for availing the water. There is no proper bathing space, women and girls have to take baths in open space. Drainage and sanitation are a big issue for this slum. There are few chambers in the slum which are not connected and because of this water does not flow from the drains, and this creates a problem of water logging. During the rainy season this slum becomes flooded. In the slum there is also major issue of accumulation of cow dungs, due to this the drainage also jammed sometimes, after warnings from PMC, it is in habitual for some people in the slum.

## Structure of the Development Plan

The plan discusses the current situation of the slums. It combines the crucial information on Demography, physical infrastructure, health and slum dynamics and sanitation indicators. The information is crucial to set up the baseline of the development plan. In the subsequent sections the plan discusses about the gap which is visible for a more robust and inclusive services for the development plan. The gap focuses on infrastructure services, social capital and strengthening the health services. The last section explicitly focuses on the intervention plans supported by the photographs. The drainage blockage and community toilets are intrinsic part of the current intervention strategy for the project.

## Current Status at a Glance (SLUM):

Sr. No.	PARTICULAR	SPECIFICATION	REMARKS
<b>Demography of the slum</b>			
79.	Nearest Landmark	Bazar Samiti Ram Ratan Hospital	
80.	Total Household	80 Approx.	
81.	Total Population	510	
82.	Majority- Caste wise/Religion wise	SC (Harijan), Paswan	
83.	Male	287 Approx.	Source: ward councilor
84.	Female	223 Approx.	
<b>Physical Infrastructure of the slum</b>			
85.	Open Space in slum, if yes then how many	No	
86.	No. of Community toilet	1	Non - Functional
87.	No. of total units/seats	12	Details provided in the next page.
88.	Community toilet run by whom? -	PMC	4 toilets of PMC
89.	Number of bore well in the slum	1	
90.	Number of functional bore wells	1	
91.	Number of hand pump	0	
92.	Number of functional hand pump	0	
93.	No. of street lights in the slums	25	6 are non functional
94.	Nearest Aanganwadi Centre (Distance from slum)	1 Aanganwadi is in the slum	Functional
<b>Health</b>			
95.	Nearest PHC (Distance from Slum)	UPHC 2km,	Sandalpur
96.	Nearest Govt. School (Distance from slum)	1 Government school in the slum	Primary school, Bahadurpur
97.	Is there Asha worker in the slum/Ward	Yes	1 ASHA worker in the slum
<b>Slum dynamics</b>			
98.	Major occupation of people living in the slum	Daily wager, Painter and female are doing house maid job.	
99.	Is there concrete road in the slum	Yes	
100.	Is there proper drainage system in the slum	No	
101.	Situation of slums during the rainy season?	Accumulation of water	Water is logged completely.
102.	No. of out of school children	08 (Age group 8 - 19)	Female - 09 & Male - 04
103.	No. of Person with disability	08 People	Locomotor Disability - Leg & Hand, Mental Disability
104.	No. of Sanitation Workers	4 SW of PMC	
<b>Sanitation</b>			
27.	Status of Door-to-door collection	Daily collection done through E-cart and Hand cart between 6 am - 11am	Kauleshwar Kumar, Mob - 7903501894
28.	Status of brooming	Processing	



## Existing gaps in the slum at the infrastructure level:

Sr. No.	Status of Infrastructure services	Numbers	Current status	Work needs to be done
25	Road	1	Damaged	Maintenance work
26	Street	3	Construction required	Construction required
27	Public Toilet	1	Non-Functional	Toilet is locked, water connection is required.
28	Drainage	1	1 main drainage	Cleaning work is required
29	Street Light	25	19 is Functional	6 is need to repair
30	Water supply	1 Borewells	Functional	
31	Earthwork	Filling and leveling of land are needed near the railway track ground		Filling & Levelling, converted into a dumping point, needs to be clean.
32	Hand pump	0	0	4 Hand pump required in the slum

<b>2.</b>	<b>Social Capital</b>	
1.	Youth Collective	30 Members
2.	Women Collective	20 Members
3.	SHG under NULM	Doesn't exist
4.	Monitoring Committee	1 group consisting of 5 members
5.	Social Action/Leadership: Discussion with collectives on social issues like Gender based violence, Child marriage, visioning in slums, Health, Sexual & reproductive health rights, Menstrual health and hygiene etc.	
<b>3.</b>	<b>Strengthen Health</b>	
1.	Aware people regarding role of UPHCs/ASHA/AWC	In Process
2.	Health/Vaccination camps: Health camps need to be organized on Monthly basis.	In Process

## Development Plan:

### Toilet:

Sr. No	Type of toilet	Seat	Issue	Remarks
1.	Community	12	Toilet is currently locked, there is no water connection in the toilet.	HH covered: 120 (Appx Population: 600 covered). Current Load on toilet: 60 people per seat. <b>Requirement: 48 seats</b>

**Note:** Total number of toilets has **12 seats**. The load over one seat is around **60** people. Seeing this there is a need of around **48 seats at present**.

## Action Required for above mentioned toilet issues:

- Water connections need to be established.
- Regular maintenance and cleanliness required
- Local community person needs to be appointed for the maintenance.
- Community awareness as the social capital should be raised to pay for the maintenance.
- Local people shifted in the toilet and started living there, they said if it opens, we will vacant the place.
- Generate social awareness among the community with the help of our collectives. Need a strong effective session.



12-seater community toilet



Local People occupied the toilet

## Blockage of drainage:

In Domkhana basti, near the old toilet the manholes are completely blocked, the dirty water of the drainage running above it, community people are facing trouble due to waterlogging and bad smells. It is also dangerous for the young children playing around.



Sr. No.	Issue	Action Required
1.	The main drainage of the slum is blocked by throwing the garbage	Need to be clean on regular basis to avoid blockage
2.	The door-to-door vehicle not able to visit in the street	Need to place a big dustbin in the slum
3.	Waste dumping	Strict messages for the fine are to print and stick on the main locations of the slum.

---

## Water Resources:

There is a need for installation of tap water in every house. Females have to fetch the water through borewells far from the houses for daily chores.



## Recommendation:

- Toilets need to be repaired on urgent basis, especially the community toilet, that chamber needs to be re-constructed.
- Open the locked community and Modular toilet behind the NCC circle office.
- The Borewell base platform needs to be repaired, broken due to water logging.
- Uneven land of the slum needs to be filled to avoid the water logging.
- Open bathing space needs to be made useful by shading and covering it with boundary walls.
- Waste collection needs to be collected door to door and brooming needs to be done on a daily basis. Dustbins are needed for the slum.
- Cow dung accumulation and disposing it right manner is needed to avoid the drainage jam.



# SLUM DEVELOPMENT PLAN



## Old and New Ambedkar Colony

Ward – 51, Bankipore Circle

## Background of the Slum

Old & New Ambedkar Colony is situated in Sandalpur area, Ward No.51. The population here is approximately 8000. People here mainly belong to Harijans and Raut (SC, ST) communities, they are residing here in the slum since 1990s. People here are engaged in cleaning work (Sweepers), some of them are associated with the municipal corporation as sanitation workers, where some people do cleaning works in private hospitals, schools, lodges.

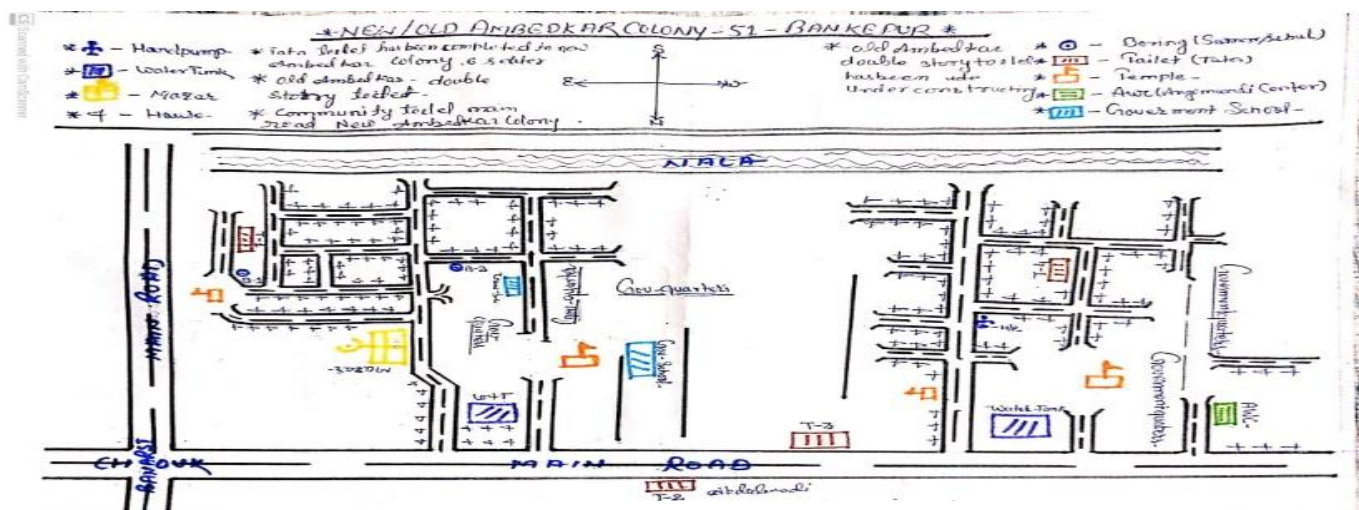

The status of education in this community is extremely low. Most of the children do not study after 10th standard. 45 percent of the children here drop out of school owing to their poor economic conditions. There is one Aganwadi Centre (AWC) in the slum. There are 30 children enrolled in Aganwadi Centre and 22 children visit it on a daily basis. Female girl child from the community is unable to attend school education due to gender discrimination. Migration is also one of the factors in access to education. Girls are mostly involved in their household chores; boys mostly contribute to household income. Some children study till 10th class but are not able to pursue their education beyond that because after 10th they are married or girls drop out of school due to school being outside their community. Owing to the safety & security of their girl child they stop sending them to school. Some people in the community are engaged in liquor making. This has led to the use of drug abuse in the youth of the community. There have been several cases of domestic violence & it has deeply affected women.

## Structure of the Development Plan

The plan discusses the current situation of the slums. It combines the crucial information on Demography, physical infrastructure, health and slum dynamics and sanitation indicators. The information is crucial to set up the baseline of the development plan. In the subsequent sections the plan discusses about the gap which is visible for a more robust and inclusive services for the development plan. The gap focuses on infrastructure services, social capital and strengthening the health services. The last section explicitly focuses on the intervention plans supported by the photographs. The drainage blockage and community toilets are intrinsic part of the current intervention strategy for the project.

## Current Status at a Glance (SLUM):

Sr No.	PARTICULAR	SPECIFICATION	REMARKS
<b>Demographic of the slum</b>			
1.	Nearest Landmark to the slum	Devi Sthan(Durga Mandir), Sandalpur	
2.	Area in Sq. Feet	5,22,720 sq. Feet (12 Acre)	
3.	Total Household	1500	
4.	Total Population	8000	
5.	Majority- Caste wise/Religion wise	Harijan, Raut	
6.	Male	5000 (Almost 3100 voters and 1900 under eighteen)	Source: ward councilor
7.	Female	3000 (Almost 2200 voters and 800 under eighteen)	
<b>Physical Infrastructure</b>			
8.	Open Space in slum, if yes then how many	No	
9.	No. of Community toilet	4	Functional: 3
10.	No. of total units/seats	37	Details provided in next page.
11.	Community toilet run by whom? -	Community member	They are not belonging to our collectives.
12.	Number of bore well in the slum	4	
13.	Number of functional bore wells	3	
14.	Number of hand pump	4	
15.	Number of functional hand pump	2	
16.	No. of street lights in the slums	53	Functional
<b>Health</b>			
17.	Nearest Aanganwadi Centre (Distance from slum)	1 Anganwadi is in the slum	Functional
18.	Nearest PHC (Distance from Slum)	700m	Name: UPHC Sandalpur
19.	Nearest Govt. School (Distance from slum)	1 Government school is in the slum	Primary school, Ambedkar colony
20.	Is there Asha worker in the slum/Ward	One Asha worker is in the slum	
<b>Slum Dynamics</b>			
21.	Major occupation of people living in the slum	Most of the people here do the cleaning work. Some are working with the Municipal Corporation and some are working in private.	
22.	Is there concrete road in the slum	Yes, the roads here are paved and concrete, except for one street.	Currently many roads are damaged due to setting of the water supplies pipe line.
23.	Is there proper drainage system in the slum	<ul style="list-style-type: none"> <li>The drainage system in Ambedkar Colony is in very poor condition. Drainage system is not fully functional in Old Ambedkar colony and it requires repair in multiple places.</li> </ul>	14 main drainages need to repair. In which 2 are completely dead and blocked



24.	Situation of slum during rainy season?	The situation is bad, rain water gets accumulated in people's houses, causing them to face health hazards.	Water is logged completely.
25.	No. of out of school children	17 (Age group 9 - 15)	Female - 14 & Male - 03
26.	No. of Sanitation worker	PMC recruited 3	
<b>Sanitation</b>			
27.	Status of Door-to-door collection	Daily collection done through E-cart and Hand cart between 6 am - 11am	Sanjeev Kumar, 9122616692
29	Status of brooming	Not initiated yet	Issue has been escalated to City Manager & CSI.

### Existing gaps in the slum at the infrastructure level:

Srl No.	Status of Infrastructure services	Numbers	Current status	Work needs to be done
17	Road	2	Raw (Kaccha)	Concrete/Paver
18	Street	6	Blocked by throwing waste, water logging & mud	Cleaning and levelling then concrete work and Paver work is needed.
19	Public Toilet	4	3 is functional	Water connection damaged in 1 toilet is needed to be repair.
20	Drainage	14	8 main and 6 sub drainages	Cleaning, repairing
21	Street Light	13	6 is not working	Repair
22	Water supply	1300	Piping work is done water supplies is on hold	Measurement, and 200 HH is still waiting for the piping and connection
23	Earthwork	Mostly in old Ambedkar colony is needed		Levelling
24	Hand pump	4	Out of order	Need to repair
<b>Social Capital</b>				
1.	Youth Collective			30 Members
2.	Women Collective			20 Members
3.	SHG under NULM			Doesn't exist in the community
4.	Monitoring Committee			1 group consisting of 3 people
5.	Social Action/Leadership: Discussion with collectives on social issues like Gender based violence, Child marriage, visioning in slums, Health, Sexual & reproductive health rights, Menstrual health and hygiene etc.			
<b>Strengthen Health</b>				
1.	Aware people regarding role of UPHCs/ASHA/AWC			In Process
2.	Health/Vaccination camps: Health camps need to be organized on Monthly basis.			In Process

## Development Plan:

### Toilet:

Sr.No.	Type of toilet	Seat	Issue	Remarks
1.	Community	12	There is no any street light in the toilet or nearby, it is difficult to go in the dark. One of the community members put the temporary bulb there. Wall is getting rough and damp	HH covered: 50 (Appx Population: 250 covered). Current Load on toilet: 25 people per seat. <b>Requirement: 13 seats</b>
2.	Community	5	Toilet seats are very dirty. Poor maintenance, tap is leaking.	HH covered:30 (Appx Population: 150 covered). Current Load on toilet: 15 people per seat. <b>Requirement: 10 seats</b>
3.	Modular	8	Seats are very dirty and jammed, poor maintenance. Many inside taps are broken. Outside taps of wash basin are broken. Surrounding of the toilet is also very dirty.	HH covered: 100 (Appx Population: 500 covered). Current Load on toilet: 50 people per seat. <b>Requirement: 42 seats</b>
4.	Community	12	Toilet seats are very dirty. Poor maintenance, tap is leaking.	HH covered: 100 (Appx Population: 500 covered). Current Load on toilet: 50 people per seat. <b>Requirement: 38 seats</b>

**Note:** Total community toilets have **37** seats in the slum, on each seat there is load of around 35 people. So, there is need of at least **100** more number of toilets seats, seeing the availability of land people having personal toilets.

### Action Required for the above-mentioned toilet issues:

- Toilet need to be clean, and clear the jammed blockage of the seats.
- Water taps need to be replaced, electric supply need to be installed in the toilets in the Modular one and community toilets of the old Ambedkar colony in the slum.
- Wash basin water tap also need to repair.
- In old Ambedkar community toilet, the way to the toilet from the community is broken and uneven that is need to be construct.



8-seater modular toilet



5-seater community toilet



12-seater community toilet



12-seater community toilet

## Open space

Srl No.	Issue	Action Required
1	The land is empty and extremely dirty and become the storage of garbage and house of pig. It is just behind the toilet no. 02.	<ul style="list-style-type: none"> <li>• Need land filling &amp; leveling.</li> <li>• Plantation is needed.</li> <li>• Suggestion from the community - The space should be use as community hall, Open bathing space or just made a shade where community gathering may be organize. Park can be construct here for the beautification of the location.</li> </ul>



## Blockage of streets:

Srl No.	Issue	Action Required
1.	The main street that connects slum to the main road is blocked by throwing the garbage and mud.	<ul style="list-style-type: none"> <li>• Need land filling &amp; levelling.</li> <li>• Paver road should be construct here.</li> <li>• The length of the block street - 250 meters</li> </ul>
2.	The door-to-door vehicle not able to visit in the street	Need to place a big dustbin on the crossroad
3.	Throwing garbage by the people	Strict messages for the fine are print and stick every main location of the slum.





## Water logging:

Srl No.	Issue	Action Required
1.	Blockage of drainage	Need to clean regular basis
2.	Broken drainage	Need to repair main drainages of the slums
3.	Gathering of garbage	Collection of garbage on regular basis from the slum
4.	Throwing garbage by the people	Strict messages for the fine is print and stick every main locations of the slum.



## Community Hall:

Srl No.	Issue	Action Required
1.	Community hall at the new Ambedkar colony in dilapidated condition	Renovation work need to be done.
2.	There is an open space is available in old Ambedkar colony beside the newly constructed toilet.	Plantation is needed Can be convert into park with side path.
3.	There is unavailability of lighting nearby old community hall	Two Street light needs to be provisioned
4.	Water connection is required, one handpump is there but that is out of order	Need to repair the hand pump
5.	Campus wall of old community hall is in damp condition	Wall painting is required and beautification through wall painting can be done.



## Drainage Blockage

Srl No.	Issue	Action Required
1.	Blockage in drainage	Drainage needs to be cleaned on regular basis
2.	8 main drainages are in broken condition	Need to be constructed again
3.	During the water pipeline supply connection, many drainages got damaged.	Repair work needs to be done
4.	Throwing garbage by the people in open drainage	Provision of door-to-door waste collection to be done



## Hand Pump

Srl No.	Issue	Action Required
1.	4 main handpump are out of order and not in use from many months	Need to be repaired





## Supply Water (Pipe Line):

Srl No.	Issue	Action Required
1.	New water pipeline is installed in the slum, but that is not in proper way, during the installation it also damages the previous supply line.	Maintenance work need to be done of the streets damaged during pipe line work
2.	One street in new Ambedkar colony has not got pipeline supply.	Need to be installed supply line in the street.



## Park Construction



Srl No.	Issue	Action Required
1.	Empty campus of the community hall is not in use and become the place of waste disposal by community	Need to design and construct a small park with 2 street light and water sources.
2.	Damp and rough compound wall	Wall painting can be done
3.	As there is community hall also, some unsocial elements are misusing the campus	Appointment of a guard after completion of the park and community hall work. Can be done



## Waste Management: Throwing of Garbage

Srl No.	Issue	Action Required
1.	Accumulation of garbage	Need Big Dustbins separate for Dry/wet waste
2.	Not proper location for throwing garbage	Provisioning of dustbin
3.	Irregular Door to door vehicle	Regular door to door waste collection needs to be provision
4.	Throwing garbage by the people open space	Provision of door-to-door waste collection to be done



### Recommendation:

- Drainages need to be clean and reconstruct as per need
- Chambers of the main drainages need to be cleaned.
- Toilets are need to be clean and repair the broken accessories
- Behind the area of the toilet in the old Ambedkar colony needs to be filled with soil and make even land. This is the dirtiest part of the slum, we can think about the construction of a small park/community hall etc.
- In this area of the toilet one street light is also needed.
- The community hall in the new Ambedkar colony needs to be repaired and painted.
- Installation of big dustbins is needed in the slum.
- Waste collection from door to door and brooming is needed on a daily basis.